

6801

O-Ring Boss Elbows and Tees Straight Thread Elbow

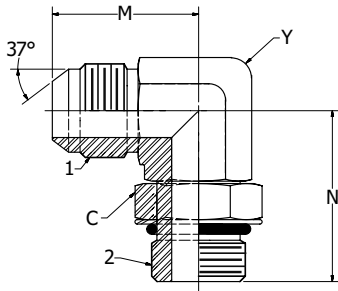

Reference
Aeroquip 2062
Parker Hose 2503
Parker Tube C50X
Weatherhead C5515
SAE 070220

Part No.	Tube O.D.	1 Male JIC	2 Male ORB	C Nut Hex	M Length	N Length	Y Flats	Operating Pressure
6801-02-02-4	1/8	5/16 - 24	5/16 - 24	7/16	0.78	0.94	7/16	6,000
6801-03-03-4	3/16	3/8 - 24	3/8 - 24	1/2	0.83	0.94	7/16	6,000
6801-04-02-4	1/4	7/16 - 20	5/16 - 24	7/16	0.89	0.92	7/16	6,000
6801-04-04-4	1/4	7/16 - 20	7/16 - 20	9/16	0.89	1.03	7/16	6,000
6801-04-05-4	1/4	7/16 - 20	1/2 - 20	5/8	0.95	1.13	9/16	6,000
6801-04-06-4	1/4	7/16 - 20	9/16 - 18	11/16	1.05	1.25	9/16	6,000
6801-04-08-4	1/4	7/16 - 20	3/4 - 16	7/8	1.12	1.45	3/4	6,000
6801-05-04-4	5/16	1/2 - 20	7/16 - 20	9/16	0.95	1.13	9/16	6,000
6801-05-05-4	5/16	1/2 - 20	1/2 - 20	5/8	0.95	1.13	9/16	6,000
6801-05-06-4	5/16	1/2 - 20	9/16 - 18	11/16	1.05	1.25	9/16	6,000
6801-06-04-4	3/8	9/16 - 18	7/16 - 20	9/16	1.06	1.19	9/16	6,000
6801-06-05-4	3/8	9/16 - 18	1/2 - 20	5/8	1.06	1.19	9/16	6,000
6801-06-06-4	3/8	9/16 - 18	9/16 - 18	11/16	1.06	1.25	9/16	6,000
6801-06-08-4	3/8	9/16 - 18	3/4 - 16	7/8	1.14	1.45	3/4	6,000
6801-06-10-4	3/8	9/16 - 18	7/8 - 14	1"	1.23	1.70	7/8	5,000
6801-06-12-4	3/8	9/16 - 18	1 1/16 - 12	1 1/4	1.31	1.94	1 1/16	6,000
6801-08-04-4	1/2	3/4 - 16	7/16 - 20	9/16	1.25	1.26	3/4	6,000
6801-08-06-4	1/2	3/4 - 16	9/16 - 18	11/16	1.25	1.32	3/4	6,000
6801-08-08-4	1/2	3/4 - 16	3/4 - 16	7/8	1.25	1.45	3/4	6,000
6801-08-10-4	1/2	3/4 - 16	7/8 - 14	1"	1.34	1.70	7/8	5,000
6801-08-12-4	1/2	3/4 - 16	1 1/16 - 12	1 1/4	1.42	1.94	1 1/16	5,000
6801-08-16-4	1/2	3/4 - 16	1 5/16 - 12	1 1/2	1.52	2.05	1 5/16	4,000
6801-10-06-4 #	5/8	7/8 - 14	9/16 - 18	11/16	1.45	1.41	7/8	5,000
6801-10-08-4	5/8	7/8 - 14	3/4 - 16	7/8	1.45	1.58	7/8	5,000
6801-10-10-4	5/8	7/8 - 14	7/8 - 14	1"	1.45	1.70	7/8	5,000
6801-10-12-4	5/8	7/8 - 14	1 1/16 - 12	1 1/4	1.54	1.94	1 1/16	5,000
6801-10-16-4	5/8	7/8 - 14	1 5/16 - 12	1 1/2	1.64	2.05	1 5/16	4,000
6801-12-06-4 #	3/4	1 1/16 - 12	9/16 - 18	11/16	1.66	1.49	1 1/16	5,000
6801-12-08-4	3/4	1 1/16 - 12	3/4 - 16	7/8	1.66	1.62	1 1/16	5,000
6801-12-10-4	3/4	1 1/16 - 12	7/8 - 14	1"	1.66	1.78	1 1/16	5,000
6801-12-12-4	3/4	1 1/16 - 12	1 1/16 - 12	1 1/4	1.66	1.94	1 1/16	5,000
6801-12-14-4	3/4	1 1/16 - 12	1 3/16 - 12	1 3/8	1.77	2.00	1 5/16	5,000

• Available in 316 Stainless Steel

Continued on next page.

4:1 Safety Factor

Minimum Order Quantity May Apply.

6801

O-Ring Boss Elbows and Tees Straight Thread Elbow

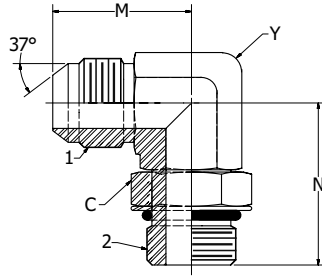

Reference
Aeroquip 2062
Parker Hose 2503
Parker Tube C50X
Weatherhead C5515
SAE 070220

Continued from previous page.

Part No.	Tube O.D.	1 Male JIC	2 Male ORB	C Nut Hex	M Length	N Length	Y Flats	Operating Pressure
6801-12-16-4	3/4	1 1/16 - 12	1 5/16 - 12	1 1/2	1.76	2.05	1 5/16	4,000
6801-12-20-4	3/4	1 1/16 - 12	1 5/8 - 12	1 7/8	1.97	2.25	1 5/8	4,000
6801-14-14-4 #	7/8	1 3/16 - 12	1 3/16 - 12	1 3/8	1.80	2.00	1 5/16	5,000
6801-16-08-4 #	1"	1 5/16 - 12	3/4 - 16	7/8	1.81	1.76	1 5/16	4,000
6801-16-10-4	1"	1 5/16 - 12	7/8 - 14	1"	1.81	1.89	1 5/16	4,000
6801-16-12-4	1"	1 5/16 - 12	1 1/16 - 12	1 1/4	1.81	2.05	1 5/16	4,000
6801-16-14-4 #	1"	1 5/16 - 12	1 3/16 - 12	1 3/8	1.81	2.05	1 5/16	4,000
6801-16-16-4	1"	1 5/16 - 12	1 5/16 - 12	1 1/2	1.81	2.05	1 5/16	4,000
6801-16-20-4	1"	1 5/16 - 12	1 5/8 - 12	1 7/8	2.01	2.25	1 5/8	4,000
6801-20-12-4 #	1 1/4	1 5/8 - 12	1 1/16 - 12	1 1/4	2.06	2.25	1 5/8	4,000
6801-20-16-4 #	1 1/4	1 5/8 - 12	1 5/16 - 12	1 1/2	2.06	2.25	1 5/8	4,000
6801-20-20-4	1 1/4	1 5/8 - 12	1 5/8 - 12	1 7/8	2.06	2.25	1 5/8	4,000
6801-20-24-4	1 1/4	1 5/8 - 12	1 7/8 - 12	2 1/8	2.20	2.39	1 7/8	3,000
6801-24-20-4	1 1/2	1 7/8 - 12	1 5/8 - 12	1 7/8	2.33	2.39	1 7/8	3,000
6801-24-24-4	1 1/2	1 7/8 - 12	1 7/8 - 12	2 1/8	2.33	2.39	1 7/8	3,000
6801-32-32-4	2"	2 1/2 - 12	2 1/2 - 12	2 3/4	3.06	2.89	2 1/2	2,000

● Available in 316 Stainless Steel

4:1 Safety Factor

Minimum Order Quantity May Apply.