

**INSTALLATION MANUAL**

**VALVE REPLACEMENT**

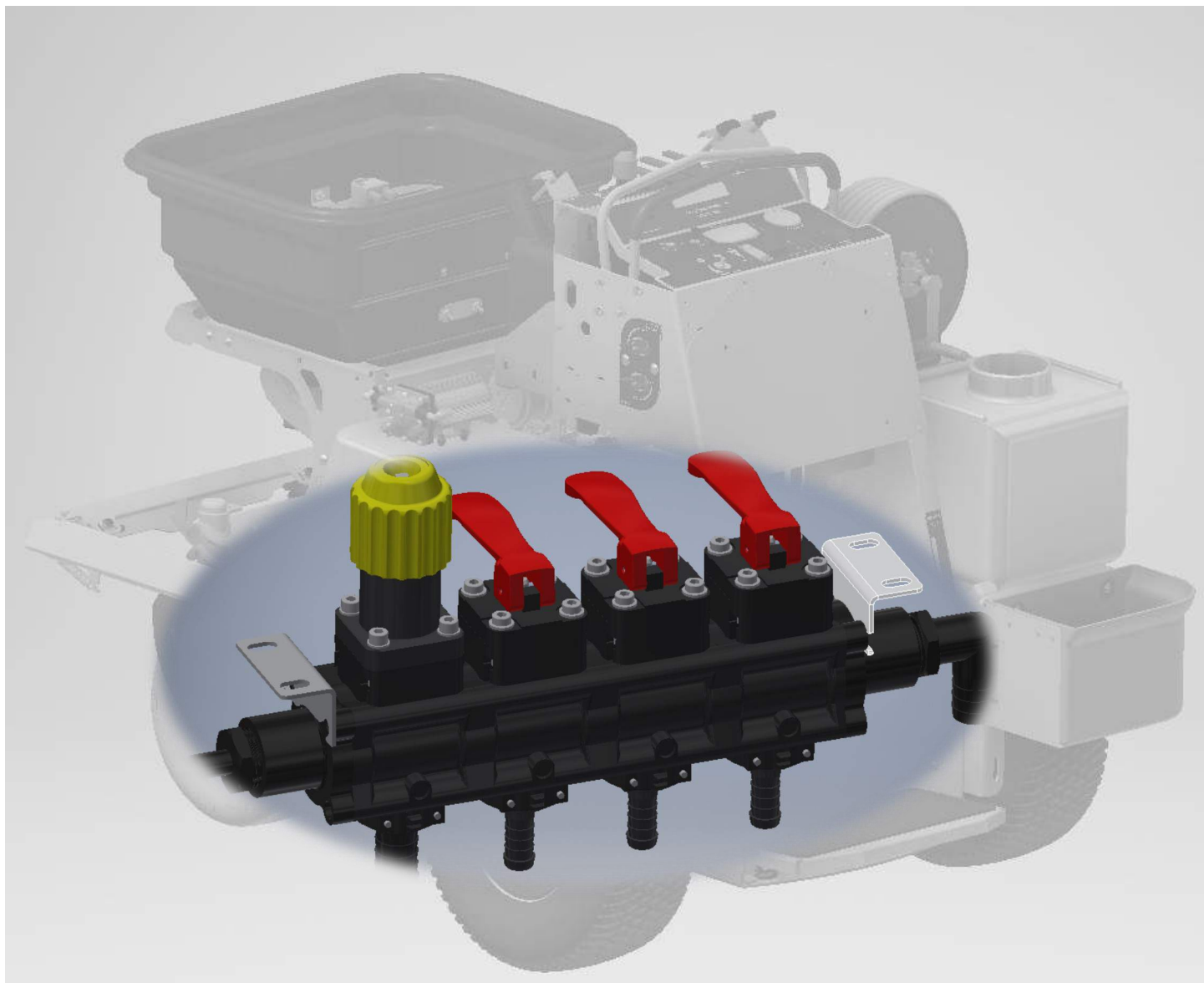

## VALVE REPLACEMENT INSTRUCTIONS

**STEP ONE:** Disconnect the battery, *ground* first and then *power* wire.



GROUND

POWER

**STEP TWO:** Disconnect and remove the fuel tank.

### CAUTION!

- Beware of excess fuel in the lines.
- Fuel spillage.

### WARNING!

- Flammable gas.

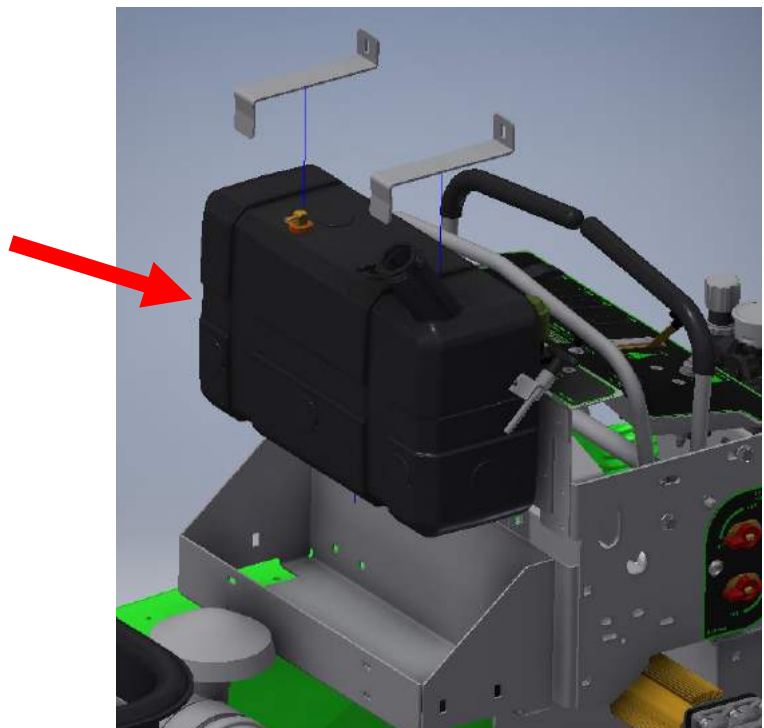

## VALVE REPLACEMENT INSTRUCTIONS

**STEP THREE:** Remove the rear dash panel.

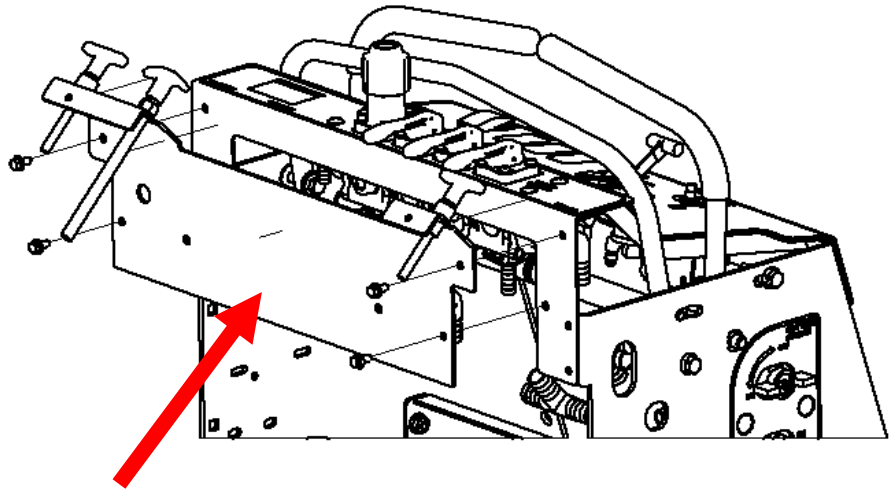

**STEP FOUR:**

- Option one: If you wish to completely remove the manifold assembly and replace the valve on a bench, disconnect all the hoses from the manifold assembly.

-Option two: If you wish to replace the valve while still attached to the sprayer, disconnect the hose from the *valve only*. Once the top bolts are removed you can replace valve as shown in *fig. 1* with out completely removing the assembly.



Fig. 1

## VALVE REPLACEMENT INSTRUCTIONS

**STEP FIVE:** Remove the top bolts to free the spray manifold.

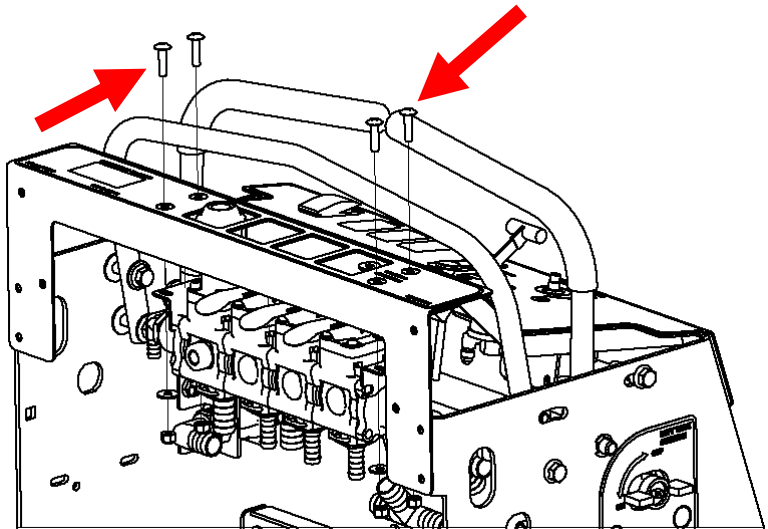

**STEP SIX:** Remove four bolts to disassemble the spray manifold.

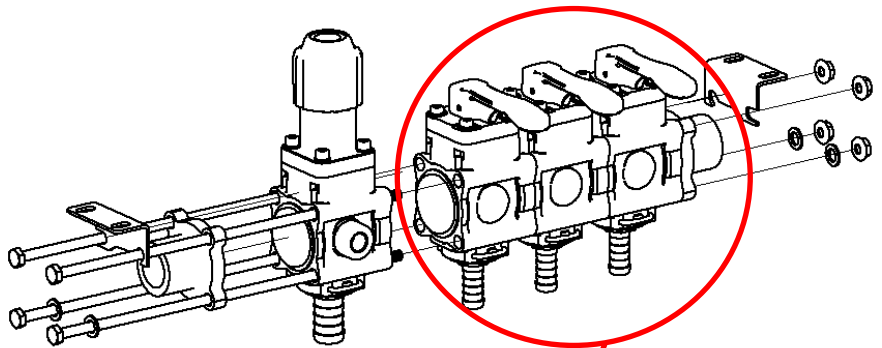

### **Assembly Tip**

*Before Starting step six, zip tie or tape the rest of the assembly together to keep it from coming apart.*

**STEP SEVEN:** Switch out the old valve with the new *Yellow knob S463071 valve*. and reassemble the manifold.

**NOTE:** Be sure and replace the new valve with the included "barb fitting".

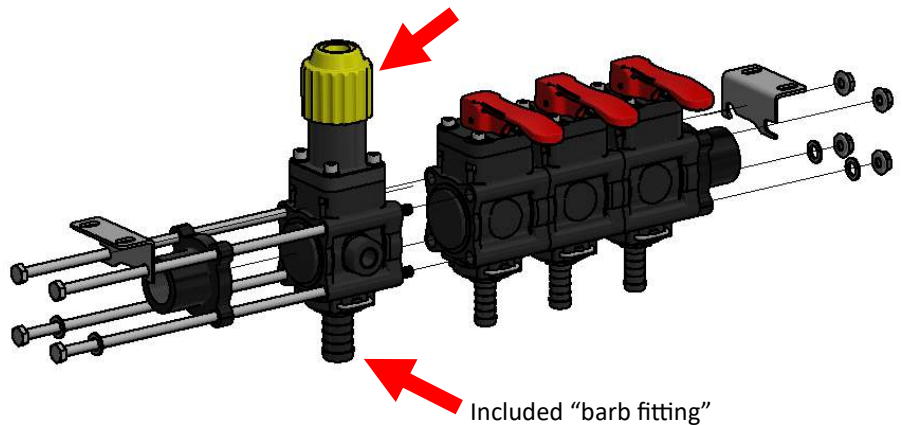

## VALVE REPLACEMENT INSTRUCTIONS

**STEP EIGHT:** Reinstall the spray manifold assembly to the dash.

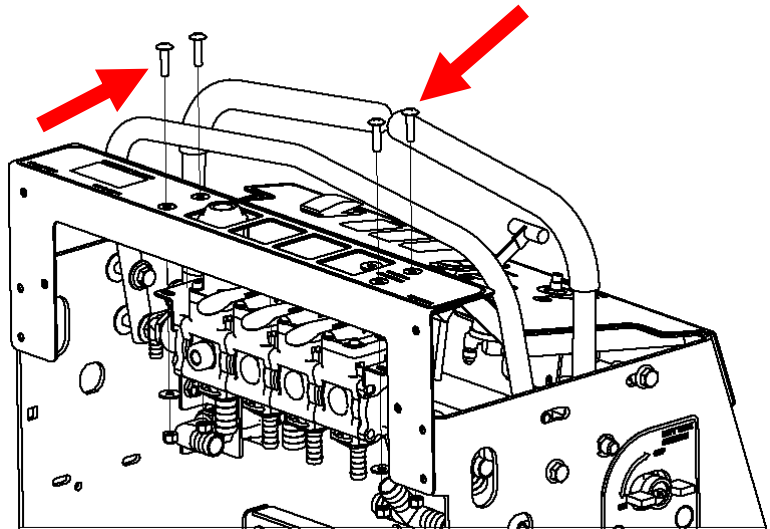

**STEP NINE:** Reinstall the rear dash panel.

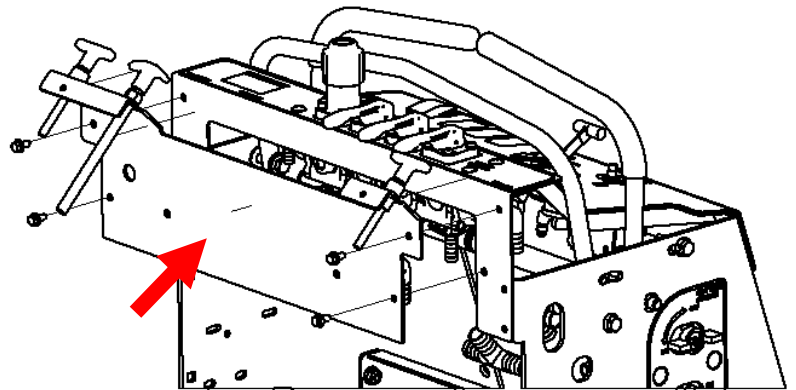

## VALVE REPLACEMENT INSTRUCTIONS

**STEP TEN:** Reinstall the fuel tank.

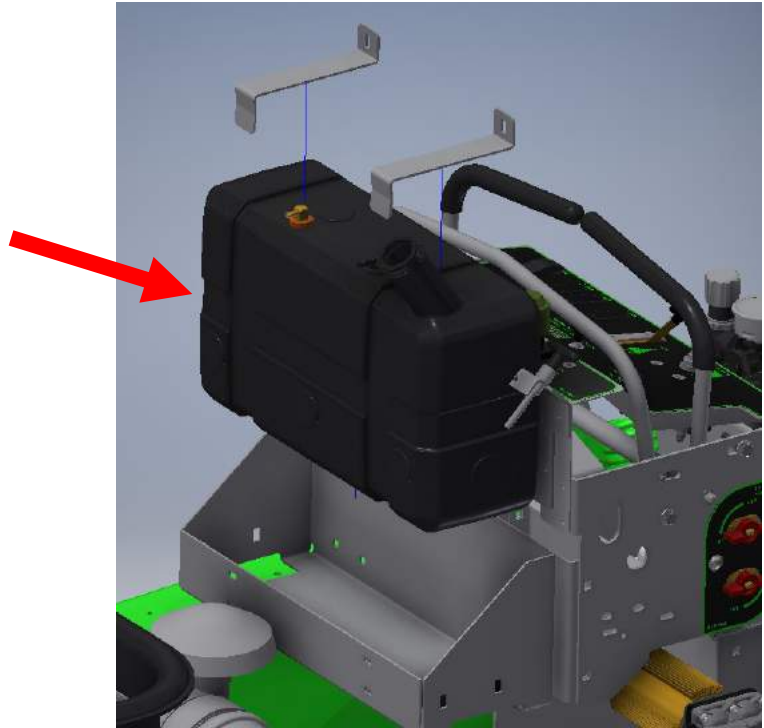

**STEP ELEVEN:** Reconnect the battery, *power* wire first and then *ground*.



GROUND

POWER



**MADE IN THE USA**

Steel Green Mfg.  
920 S State Road 39  
Lebanon, IN 46052  
(756)-481-2890  
[www.steelgreenmfg.com](http://www.steelgreenmfg.com)

SG Valve Replacement S463071