

INSTRUCTION MANUAL

PARKING BRAKE CABLE REPLACEMENT

Models: SG36, SG42, SG46, & SG52

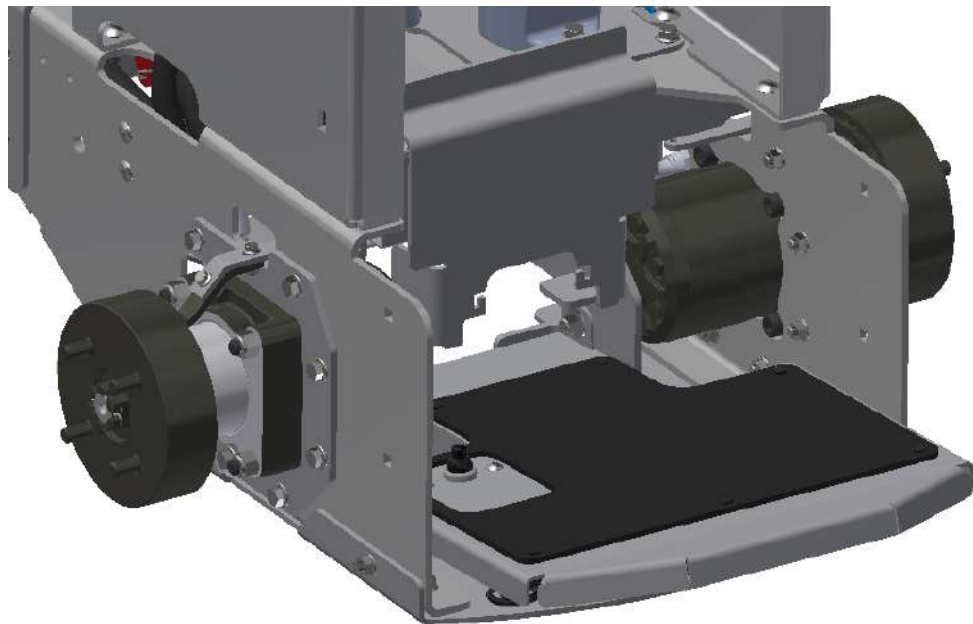

PARKING BRAKE CABLE REPLACEMENT INSTRUCTIONS

NOTE: Instructions are the same for both sides.

STEP ONE: Loosen the lug nuts and remove the rear tire.



NOTE:

- The orientation of the cables from side to side, they cross from left to right and right to left.
- Depending on the machine the wheel motor bracket and cable support brackets will be on the outside of the frame.

STEP TWO:

- Be sure the parking pedal is in the “UP” position to release the tension on the springs.
- **SG36** Unfasten the clevis to disconnect the cable from the pedal.

See next page for SG52.

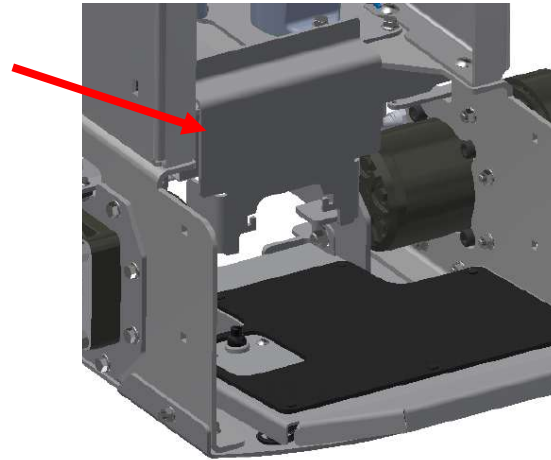

A

SG36 RIGHT SIDE

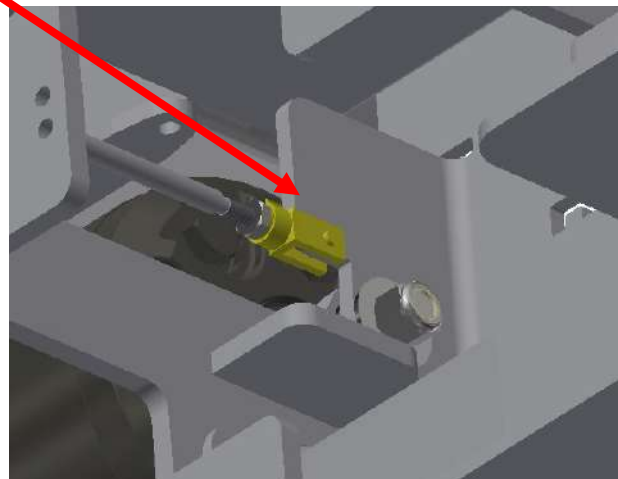

PARKING BRAKE CABLE REPLACEMENT INSTRUCTIONS

- **SG52** Unfasten the clevis to disconnect the cable from the wheel motor bracket.

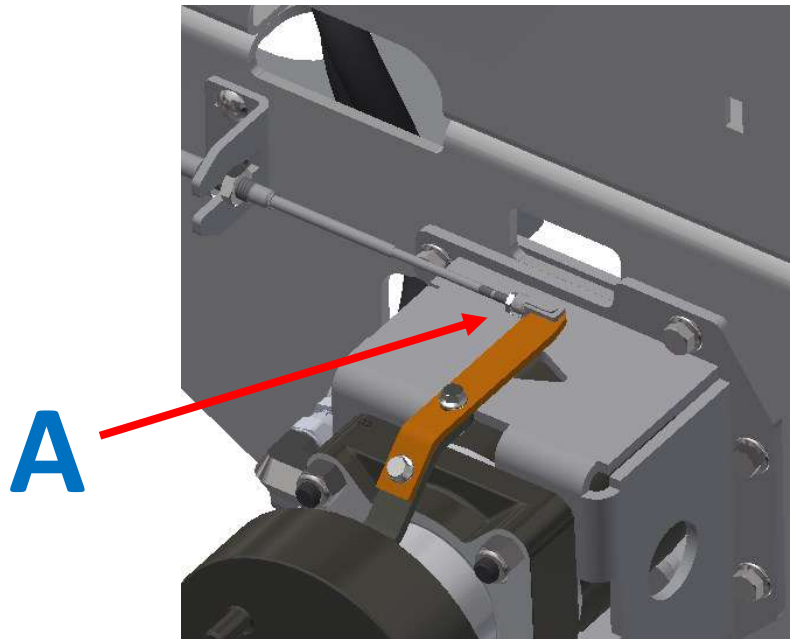

SG52 LEFT SIDE

STEP THREE:

- **SG36** Loosen the adjustment nuts to free the cable from the bracket.

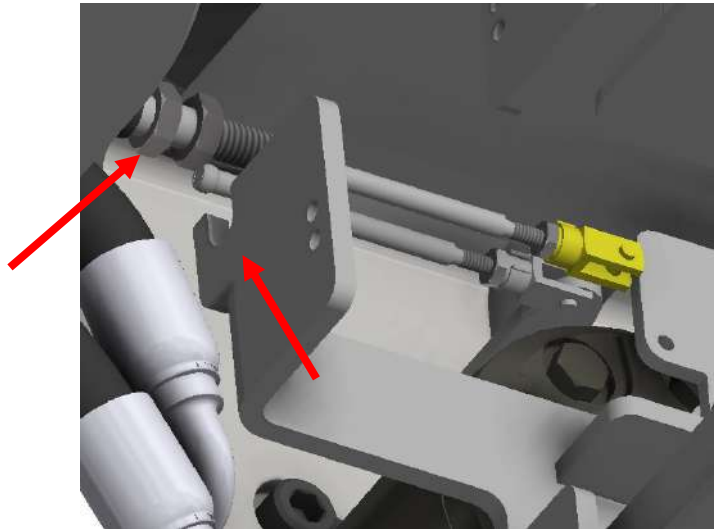

- **SG52** Loosen the adjustment nuts to free the cable from the support bracket.

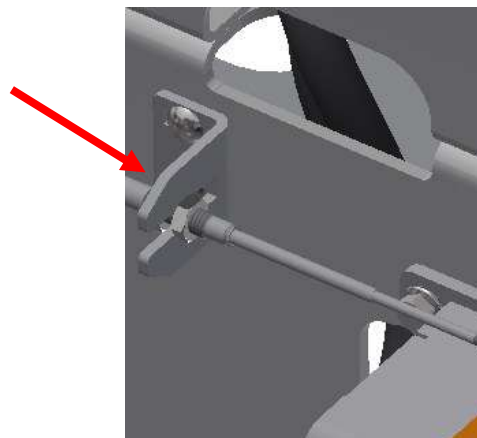

PARKING BRAKE CABLE REPLACEMENT INSTRUCTIONS

STEP FOUR:

- **SG36** Unfasten the clevis to disconnect the other end of the cable from the wheel motor bracket.

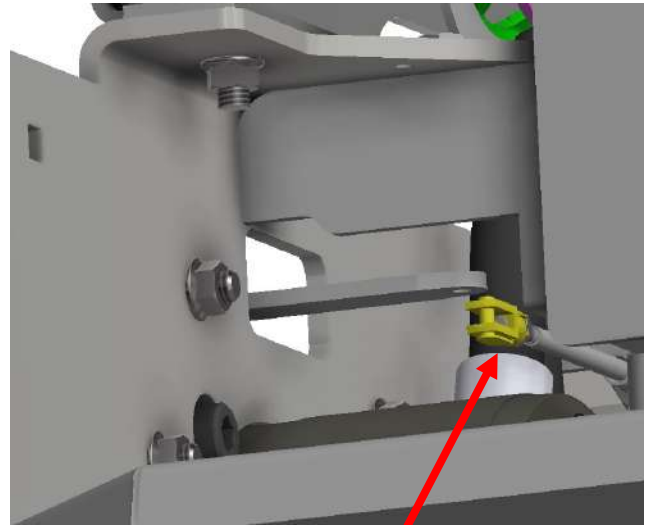

SG36 LEFT SIDE

A

ASSY. TIP: The brake pedal on the SG52 unit can now be placed in the down position for easier access to the cables.

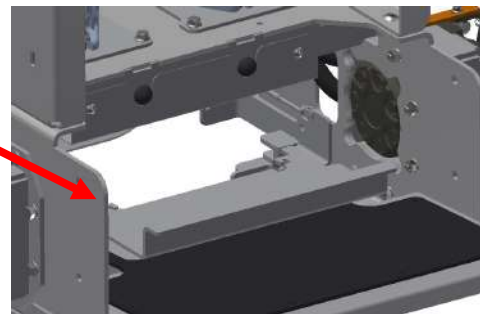

- **SG52** Disconnect the clevis from the pedal.
- Loosen the adjustment nuts to free the cable from the bracket.

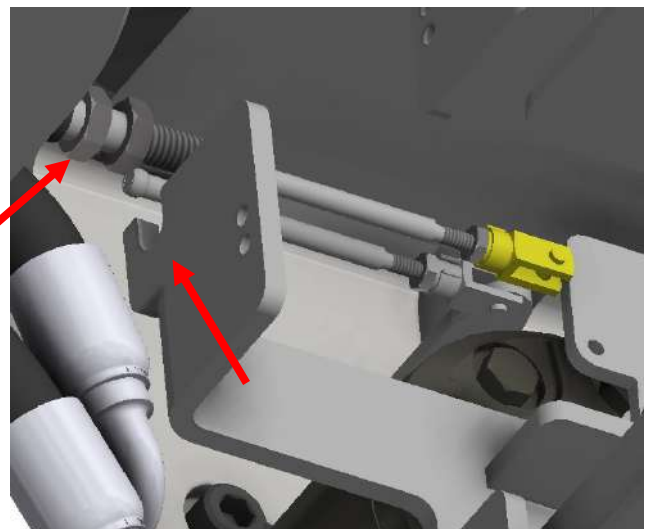

SG52 RIGHT SIDE

PARKING BRAKE CABLE REPLACEMENT INSTRUCTIONS

STEP FIVE: Loosen the adjustment nuts to free the cable from the support bracket.

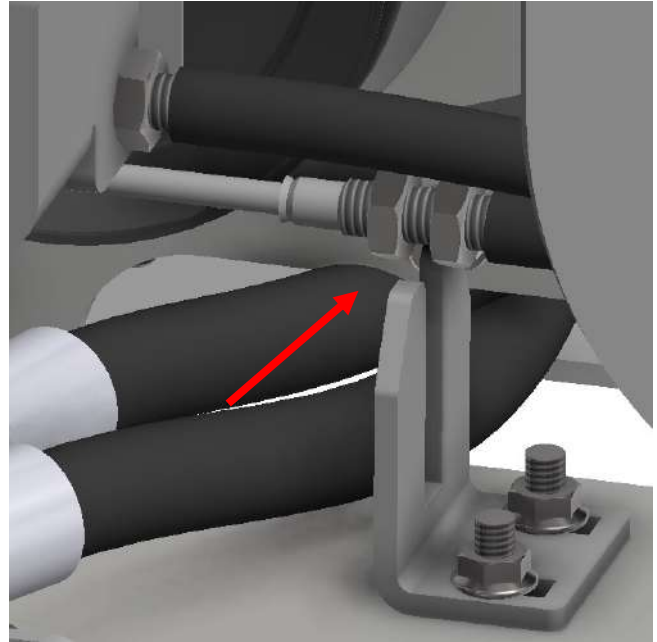

SG36 LEFT SIDE

NEW CABLE INSTALATION

NOTE: Repeat this step for the other end of the cable, (2) cables.

STEP ONE: Attach the clevis (2447K110) to parking brake cable (D71018).



PARKING BRAKE CABLE REPLACEMENT INSTRUCTIONS

NOTE: Instructions are the same for right and left sides..

STEP TWO:

- **SG36** Attach one end of the cable to the support bracket.

A

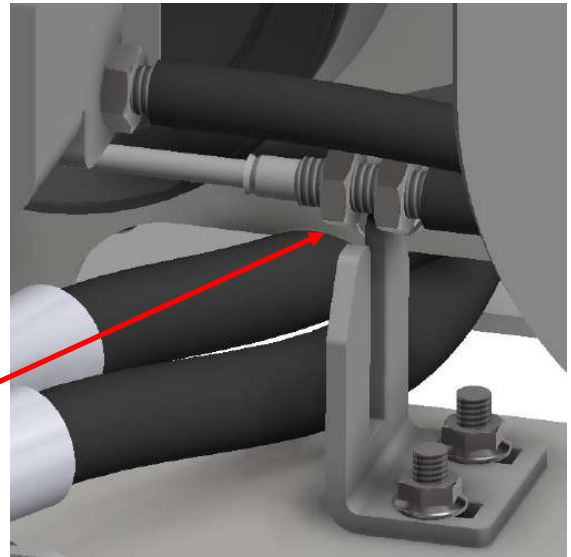

SG36 LEFT SIDE

- **SG52** Attach one end of the cable to the brake pedal support bracket on the **RIGHT SIDE**.
- Attach the clevis to the hole in the brake pedal.

A

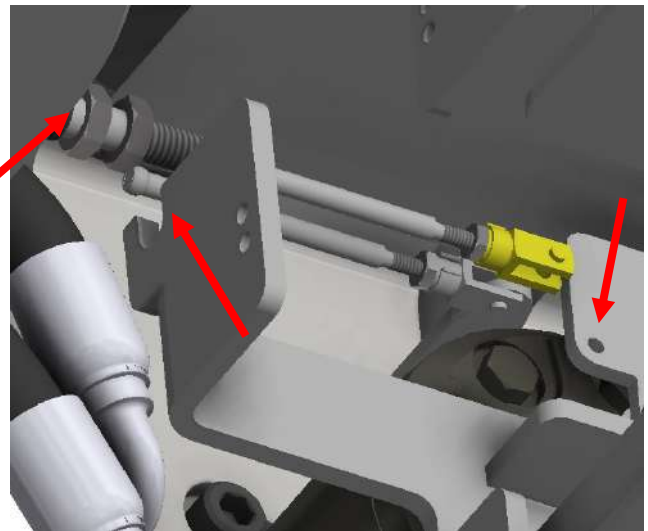

SG52 RIGHT SIDE

PARKING BRAKE CABLE REPLACEMENT INSTRUCTIONS

STEP THREE:

SG36

- Route the cable along the cross member away from moving parts to the opposite side (Fig 1).
- Attach the other end of the cable to the brake pedal support bracket on the **RIGHT SIDE**.
- Attach the clevis to the hole in the brake pedal.



Fig 1

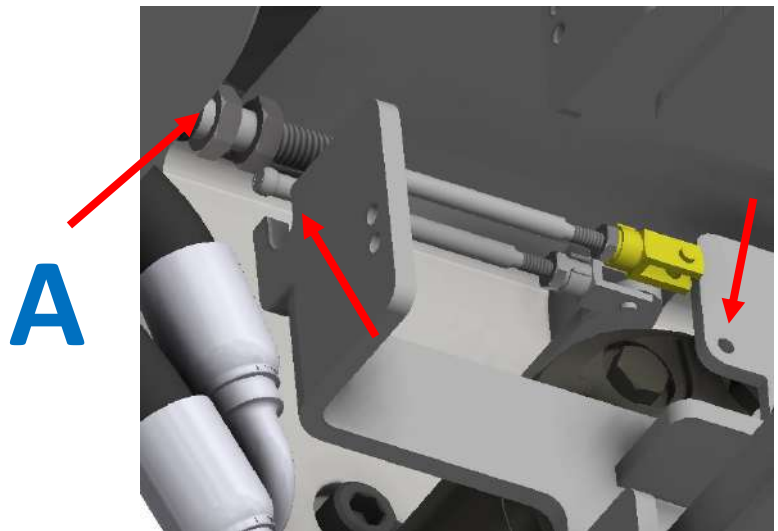

SG36 RIGHT SIDE

SG52

- Attach the other end of the cable to the LEFT side support bracket.

NOTE: Be sure the cable is aligned with the hole in the wheel motor bracket before fastening the clevis..

- Attach the clevis to the hole in the wheel motor bracket.

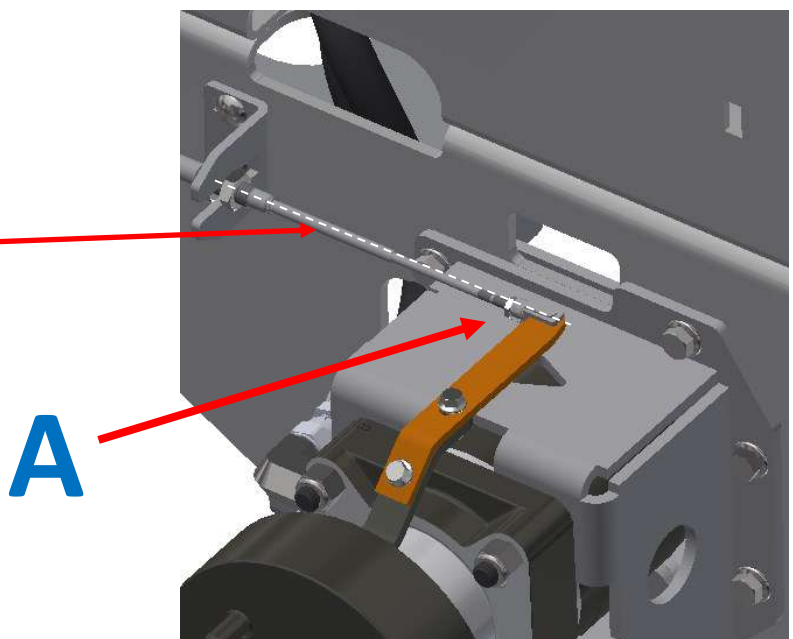

SG52 LEFT SIDE

PARKING BRAKE CABLE REPLACEMENT INSTRUCTIONS

STEP FOUR: SG36 Attach The clevis to the wheel motor bracket.

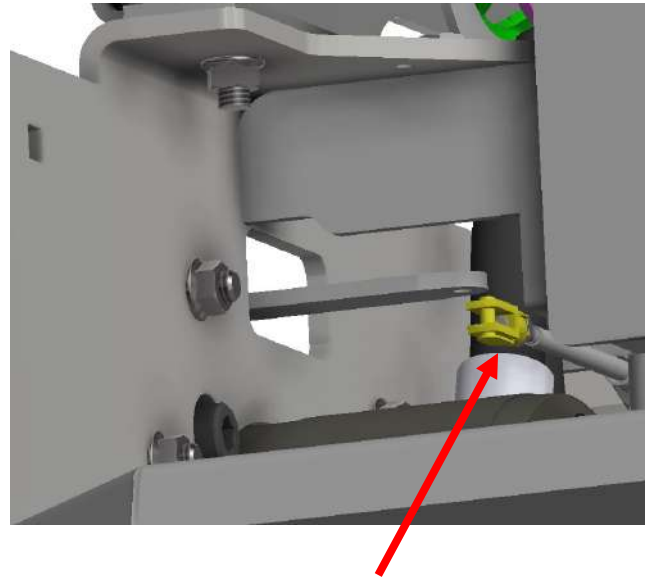

STEP FIVE: Neatly zip tie both cables to the frame cross member.



PARKING BRAKE CABLE REPLACEMENT INSTRUCTIONS

CABLE ADJUSTMENT SG36/SG52

- With the brake pedal in the **"UP POSITION"** (Fig. 2), adjust the brake cable until the wheel motor bracket is straight (Fig.3).
- Repeat this step for the **RIGHT** side.

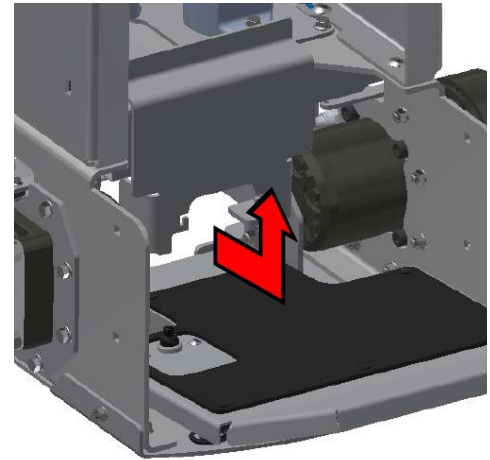

Fig. 2

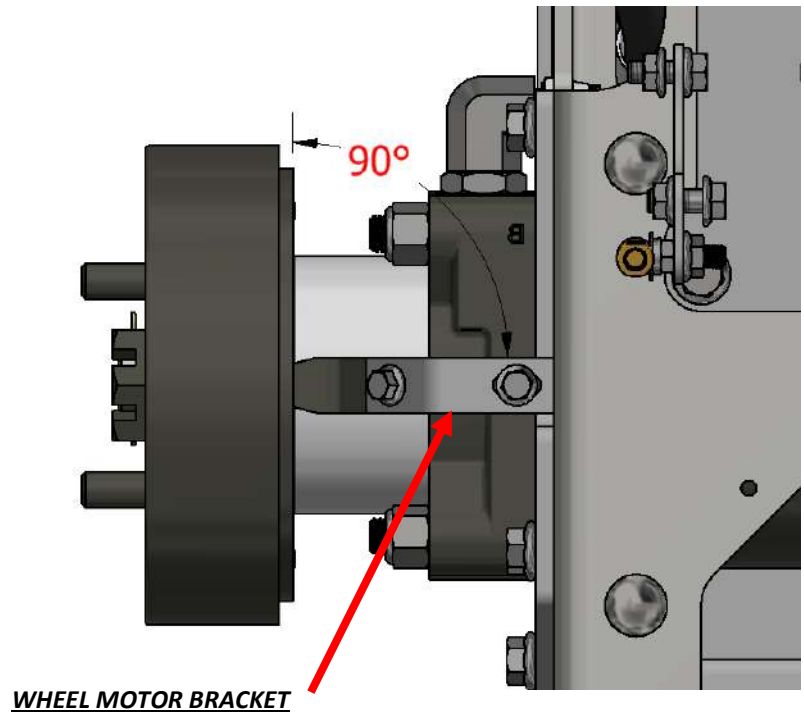
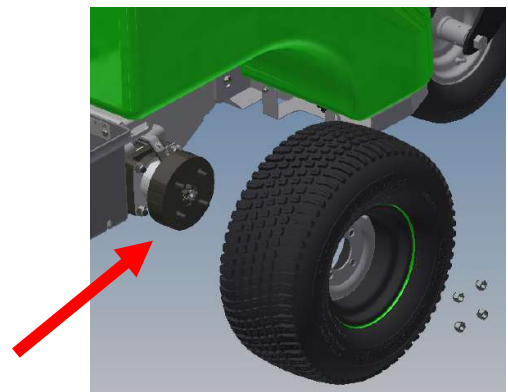

Fig. 3

- Reattach the rear tires.





MADE IN THE USA

Steel Green Mfg.
824 S State Road 39
Lebanon, IN 46052
(765)-481-2890
www.steelgreenmfg.com

MANUAL PART NO.	MANUAL REV.	DESCRIPTION
SGM-030	B	SG PARKING BRAKE CABLE REPLACEMENT