

# HOPPER CONTROL VALVE ASSEMBLY

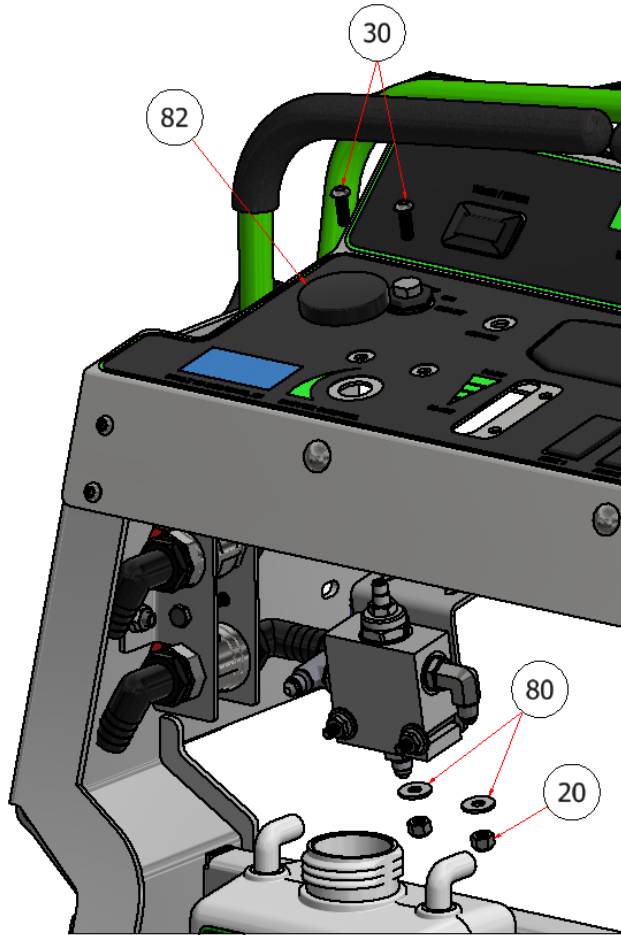

| PARTS LIST |     |             |                       |
|------------|-----|-------------|-----------------------|
| ITEM       | QTY | PART NUMBER | DESCRIPTION           |
| 20         | 6   | SSNNC-14    | NYLOCK, SS - 1/4-20   |
| 30         | 14  | PTSS-1434   | STAR SCREW, 1/4 X 3/4 |
| 80         | 10  | FWSS-14     | FLAT WASHER, SS - 1/4 |
| 82         | 1   | H81431      | VALVE KNOB            |

| EXPLODED VIEW |      |                               |
|---------------|------|-------------------------------|
| PART NO.      | REV. | DESCRIPTION                   |
| SGEV-015      | A    | HOPPER CONTROL VALVE ASSEMBLY |