

# STEELGREEN<sup>TM</sup>

## MANUFACTURING

### INSTRUCTION MANUAL

#### PRESSURE CONTROL SYSTEM ATTACHMENT

Models: SG36, SG42, SG46, & SG52

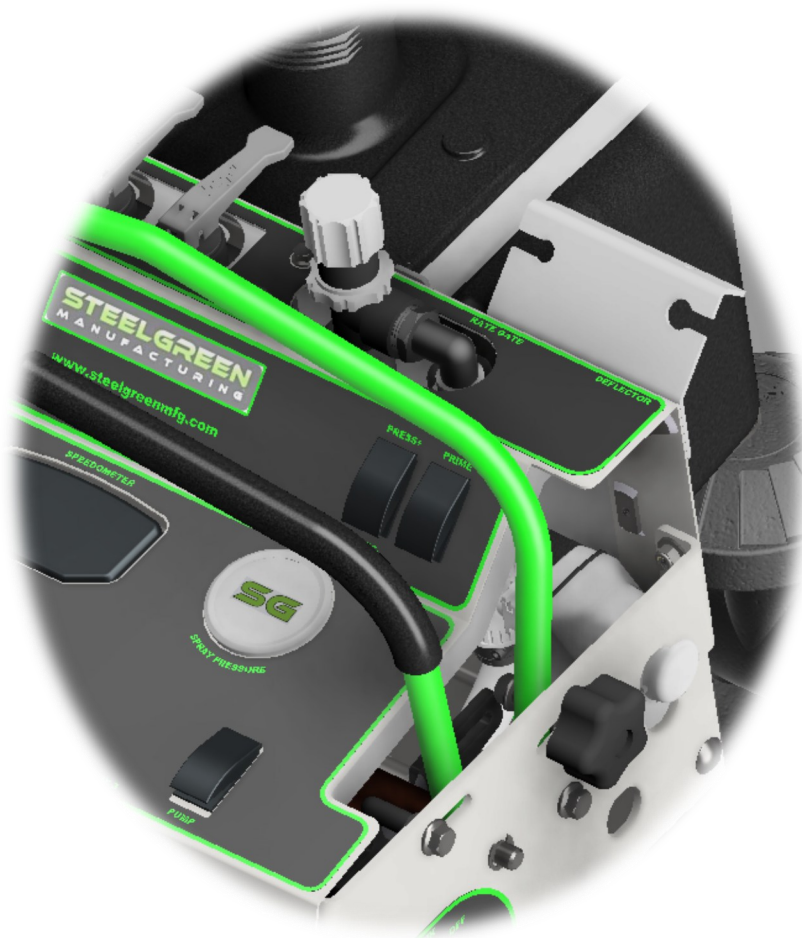

# PRESSURE CONTROL SYSTEM KIT



RATE CONTROL KIT A10058			
ITEM	QTY.	PART NUMBER	DESCRIPTION
1	1	C60362	PRIME DECAL
2	1	C60363	PRESS + DECAL
3	1	C60364	PRESS - DECAL
4	1	E40202-3 WAY	SWITCH, PUMP ROCKER 3 Way
5	1	E40202-40	SWITCH, PUMP ROCKER 40 AMP
6	1	S52004	TEE, 1/4 BARB X 1/4 NPT F
7	1	S54019	KZ VALVE TX2
8	1	S54020	PID LOOP PRESSURE CONTROLLER
9	1	S54034	PRESSURE SENSOR
10	1	SG-FC	FLOW CONTROL PIGTAIL
11	2	HFSSC-1012	HEX BOLT, #10 X 1/2
12	2	HFNCS-10S	HEX NUT, #10

# PRESSURE CONTROL SYSTEM ASSEMBLY INSTRUCTIONS

## **CAUTION**

*Before attempting any of the following steps, be sure there is no pressure on the spray system and tanks are drained.*

**STEP 1:** Disconnect the battery, *ground* first and then *power* wire.



GROUND

POWER

ENGINE SUPPLY LINE

PRESSURE RELIEF

**STEP 2:**

- Squeeze the hose clamp and slide it back.
- Disconnect both fuel lines.
- Remove the fuel tank.

## **CAUTION**

*-Beware of excess fuel in the lines.*

*-Fuel spillage.*



## **WARNING**

*-Flammable gas.*

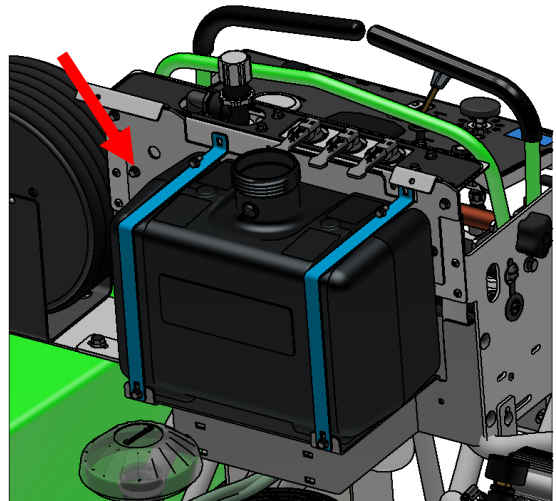

# PRESSURE CONTROL SYSTEM ASSEMBLY INSTRUCTIONS

## STEP 3:

- Remove the upper panel.

### NOTICE

*It may not be necessary to remove the hopper controls. Once the panel is free, lay the whole assembly over the hopper.*

#### PARTS LIST

ITEM	QTY	PART NUMBER	DESCRIPTION
11	10	HFSSC-145	HEX FLANGE BOLT, SS - 1/4-20 x 1/2
29	1	R21-079	SG CABLE MOUNT

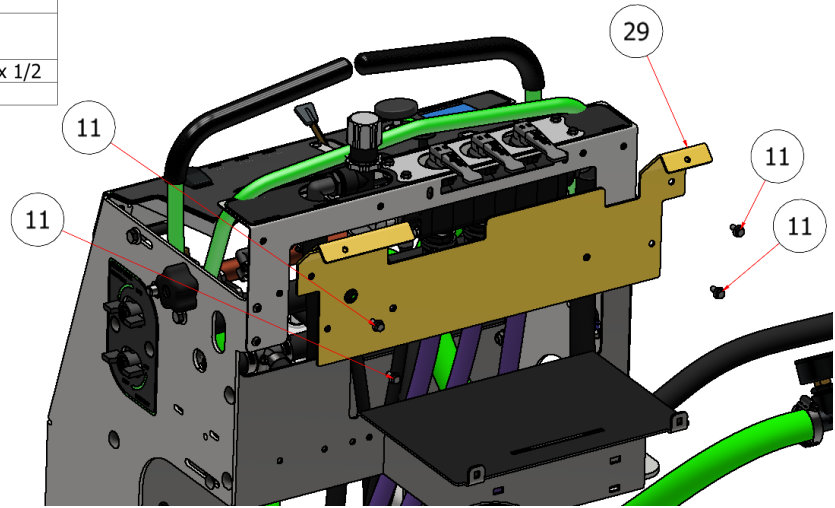

- Remove the fuel tank support.

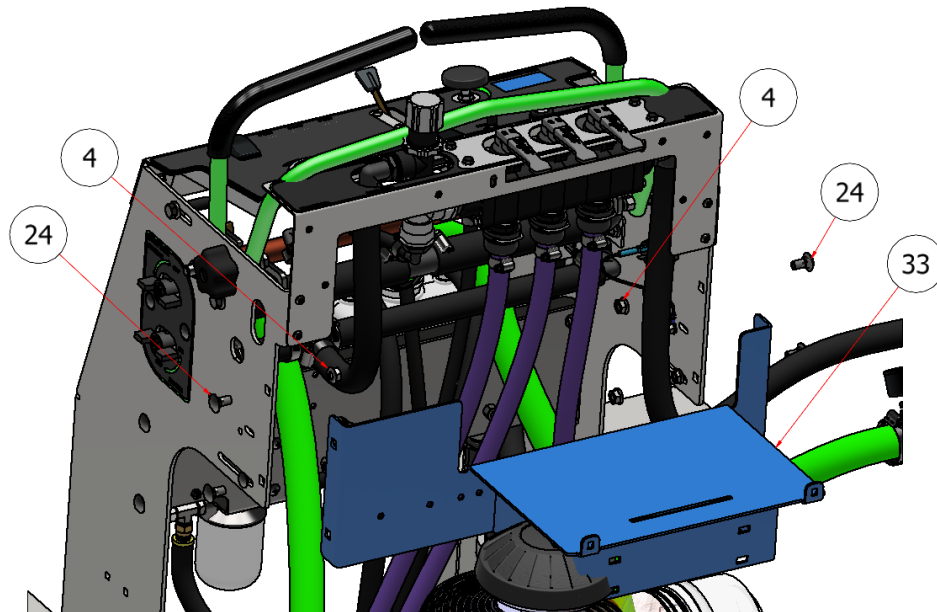

#### PARTS LIST

ITEM	QTY	PART NUMBER	DESCRIPTION
4	10	HFNCS-38S	HEX FLANGE NUT, SS - 3/8-16
24	4	CB-3834SS	CARRIAGE BOLT, SS - 3/8-16 x 3/4
33	1	W21-247	FUEL TANK SUPPORT

## PRESSURE CONTROL SYSTEM ASSEMBLY INSTRUCTIONS

### STEP 4:

- Locate the 3/4" hose connected to the throttle control valve and return hose.
- Cut the hose 4" from the top end.
- Locate the 3/8" hose from the pressure gauge "tee fitting" to the hose reel.
- Cut the 3/8" hose 3" from the "elbow fitting".

### NOTICE

*Optional cutting method: Disconnect the hoses, cut the length off the end and reconnect the cut hose pieces.*

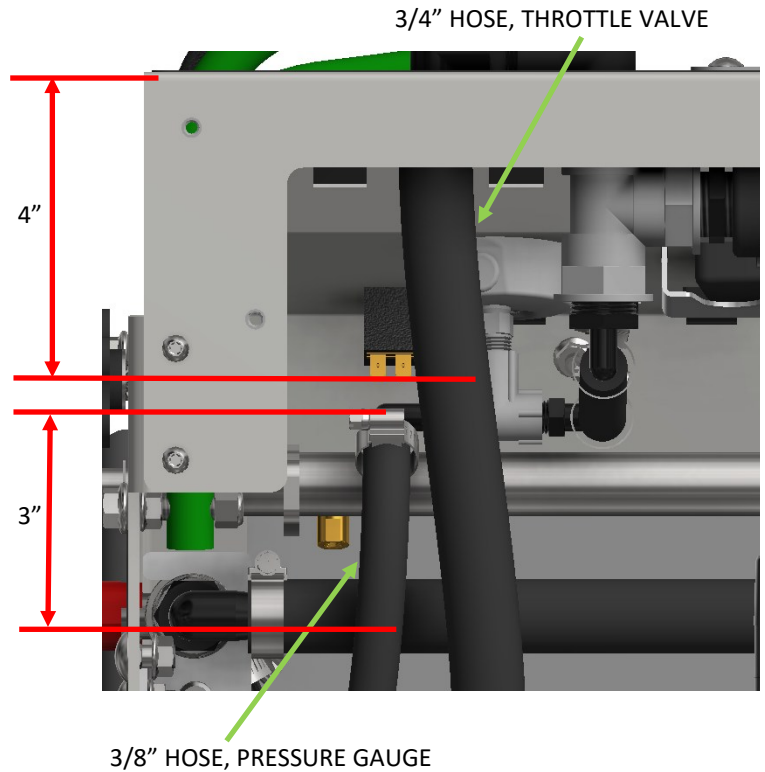

- Loosen the hose clamp and remove the lower portion of the hose assy.

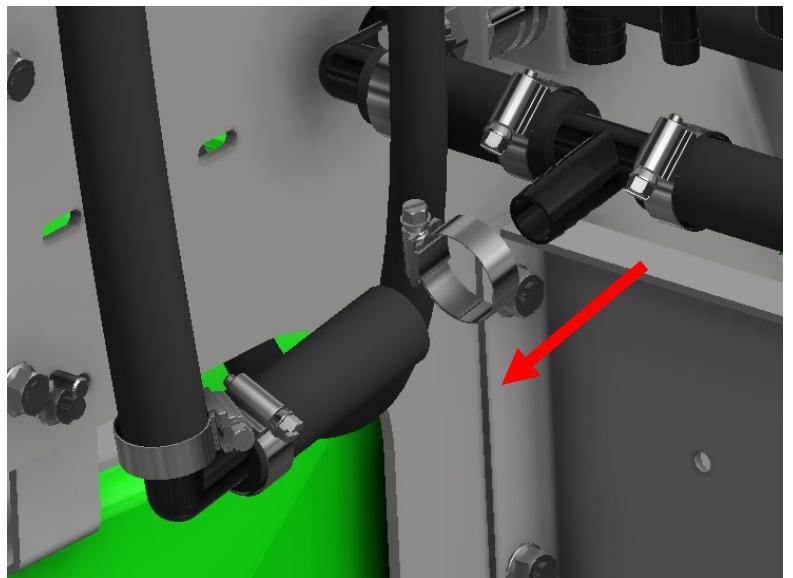

## PRESSURE CONTROL SYSTEM ASSEMBLY INSTRUCTIONS

### STEP 5:

- Connect the KZ valve assembly to the throttle valve hose as shown (S54019).
- Securely fasten the valve assembly with the hose clamp.

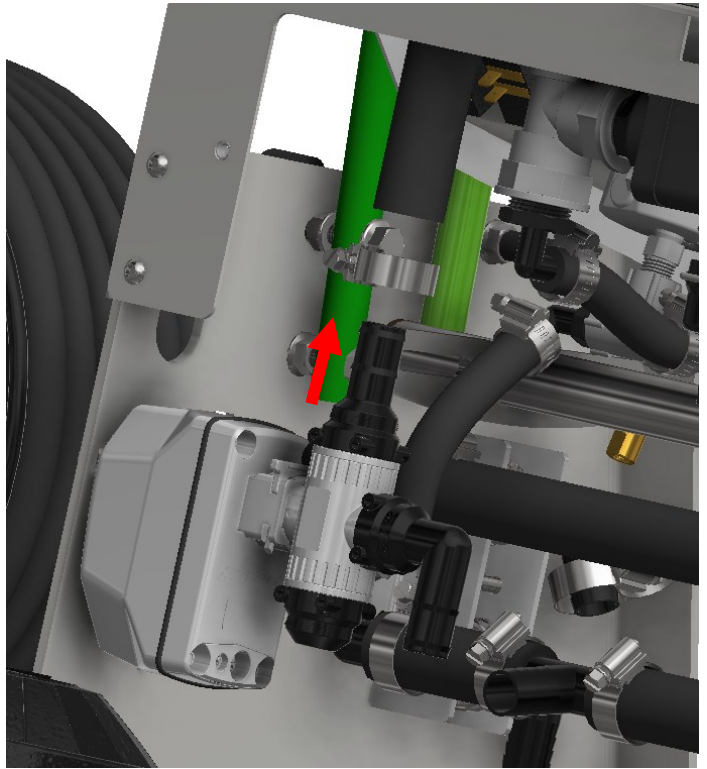

### STEP 6:

- Cut 8" of the 3/4" hose from the removed portion.
- Connect one end to the elbow fitting on the KZ valve.
- Securely fasten with 3/4" hose clamp.

A

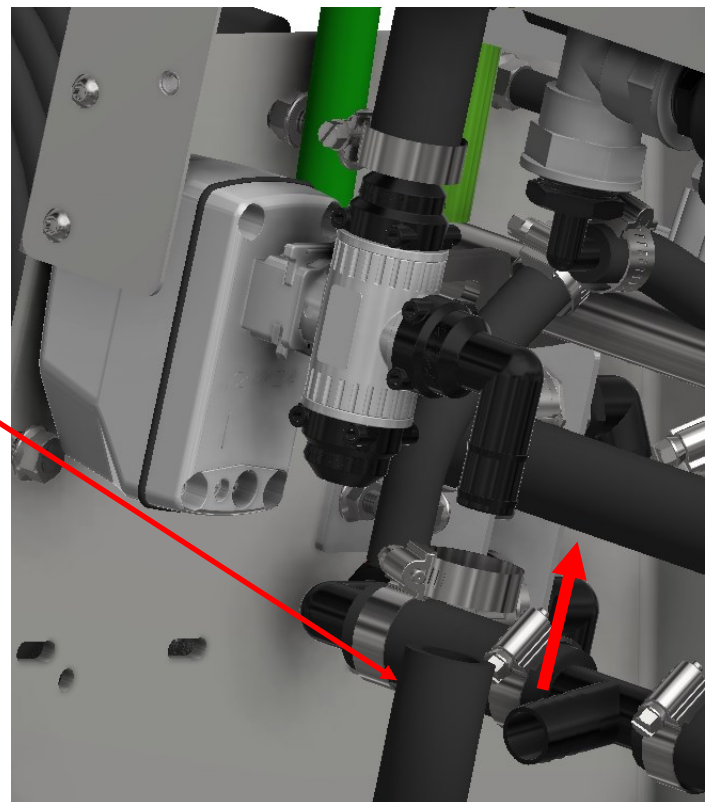

## PRESSURE CONTROL SYSTEM ASSEMBLY INSTRUCTIONS

- Connect the other end to the “tee fitting” in the return line.
- Securely fasten with 3/4” hose clamp.

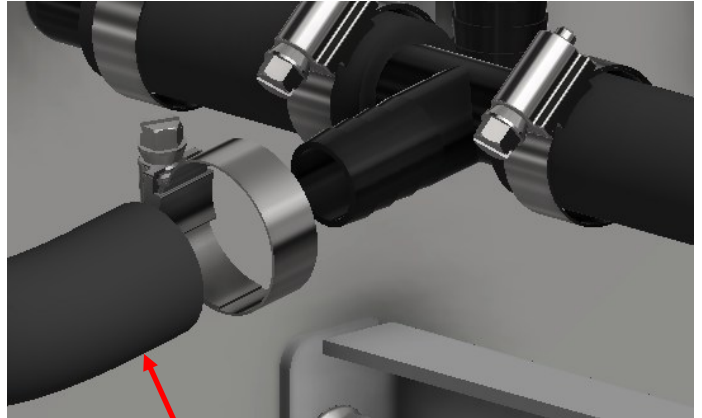

A

### STEP 7:

- Connect the pressure sensor assembly to the 3/8” hose (S54034 & S52004).
- Securely fasten with 3/8” hose clamp.

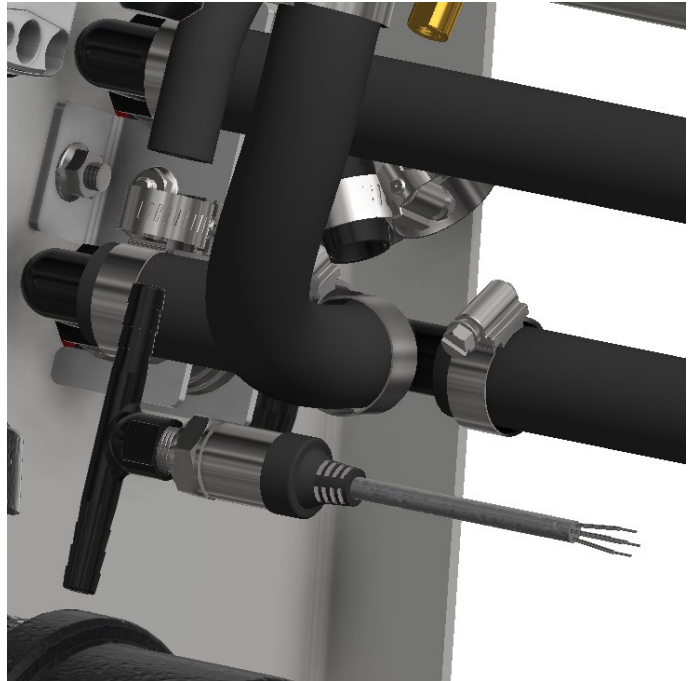

## PRESSURE CONTROL SYSTEM ASSEMBLY INSTRUCTIONS

- Connect the 3/8" hose from the hose reel to the pressure sensor "tee fitting".
- Securely fasten with 3/8" hose clamp.

### NOTICE

*Trim the 3/8" hose as needed.*



### STEP 8:

- Peel & remove the upper dash decal.
- Clean the area to remove any access glue.

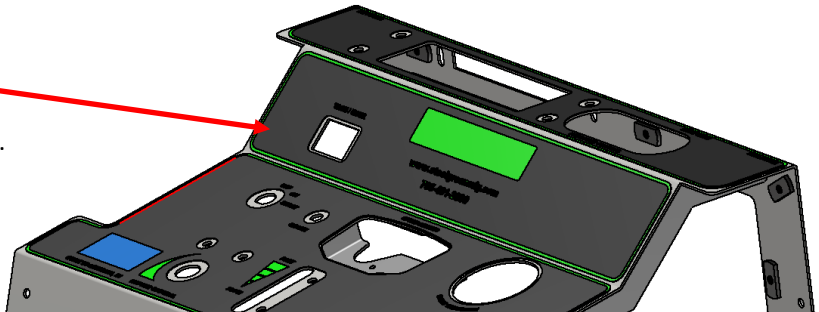

- Apply the new decal included with the kit to the dash panel.



# PRESSURE CONTROL SYSTEM ASSEMBLY INSTRUCTIONS

**STEP 9:** Attach the rocker switches to the dash as shown.

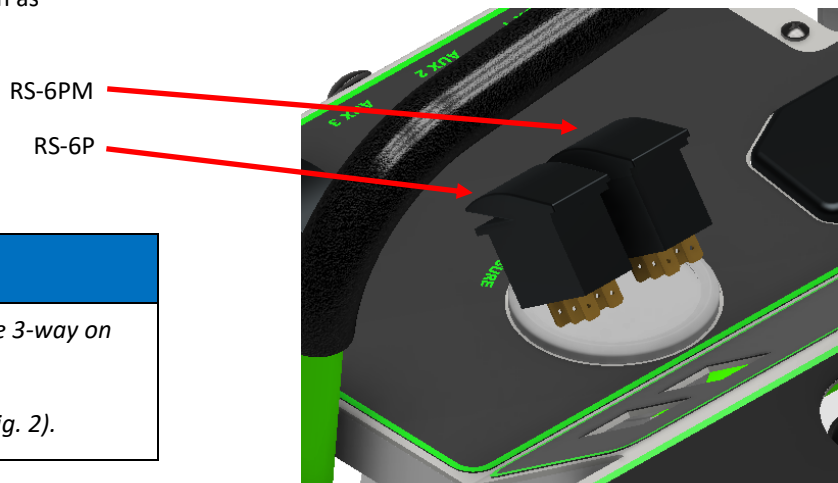

## NOTICE

- The 2-way switch goes on the left and the 3-way on the right (Fig. 1).
- The long end of the switch faces down (Fig. 2).

Fig. 1

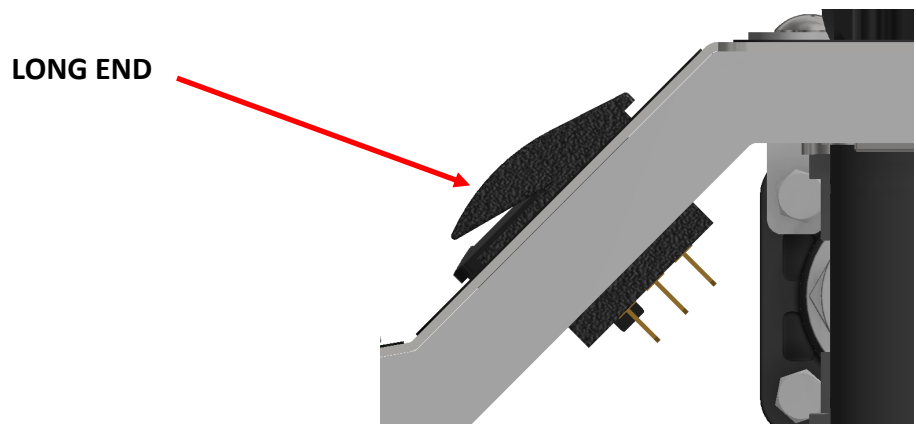
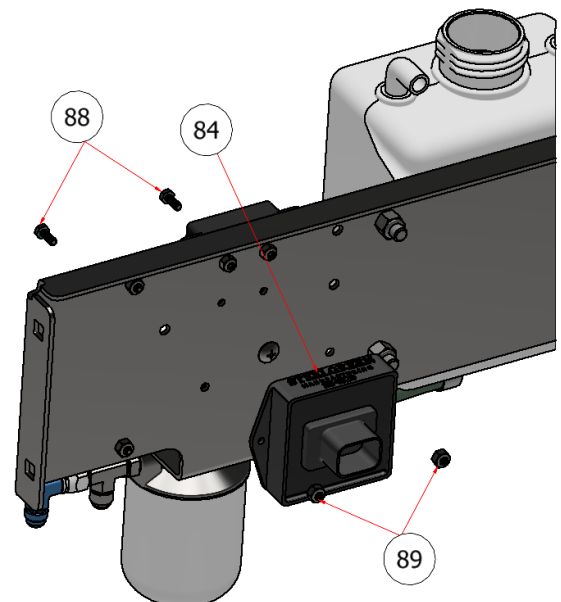

Fig. 2

**STEP 10:** Attach the controller (S54020) to the back side of the upright cross member. (provided with the kit).

PARTS LIST			
ITEM	QTY	PART NUMBER	DESCRIPTION
84	1	S54020	CONTROLLER, RATE
88	2	HFSSC-1012	BOLT, #10-32 X 1/2
89	2	SSNNC 10-32B	HEX NUT, NYLOCK, 10-32SS



# PRESSURE CONTROL SYSTEM ASSEMBLY INSTRUCTIONS

## PRESSURE CONTROL HARNESS

PART NO. - SG-FC-2

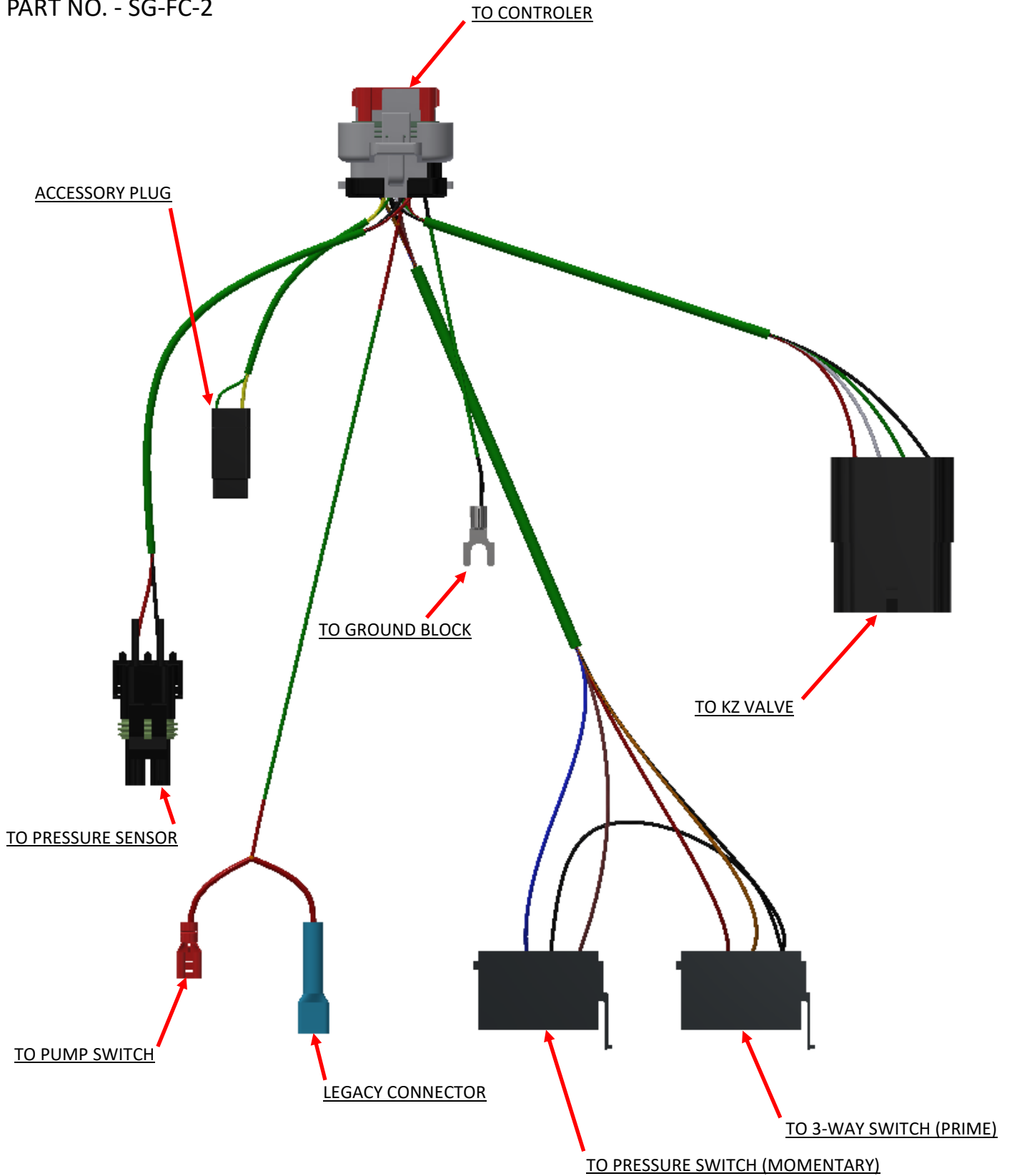

# PRESSURE CONTROL SYSTEM ASSEMBLY INSTRUCTIONS

## NOTICE

- *Route the harness neatly, away from sharp edges and moving parts .*
- *Use zip ties as needed.*

### STEP 11:

- Plug the wire harness into the controller.

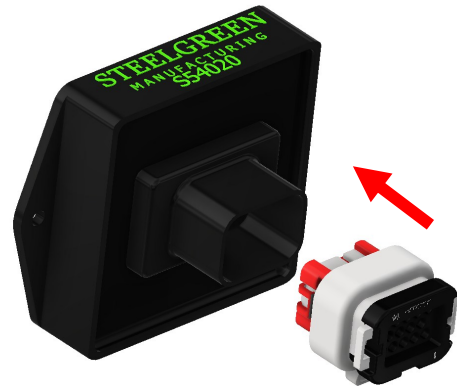

**STEP 12:** Plug the rocker switch blocks to the rocker switches under the dash.

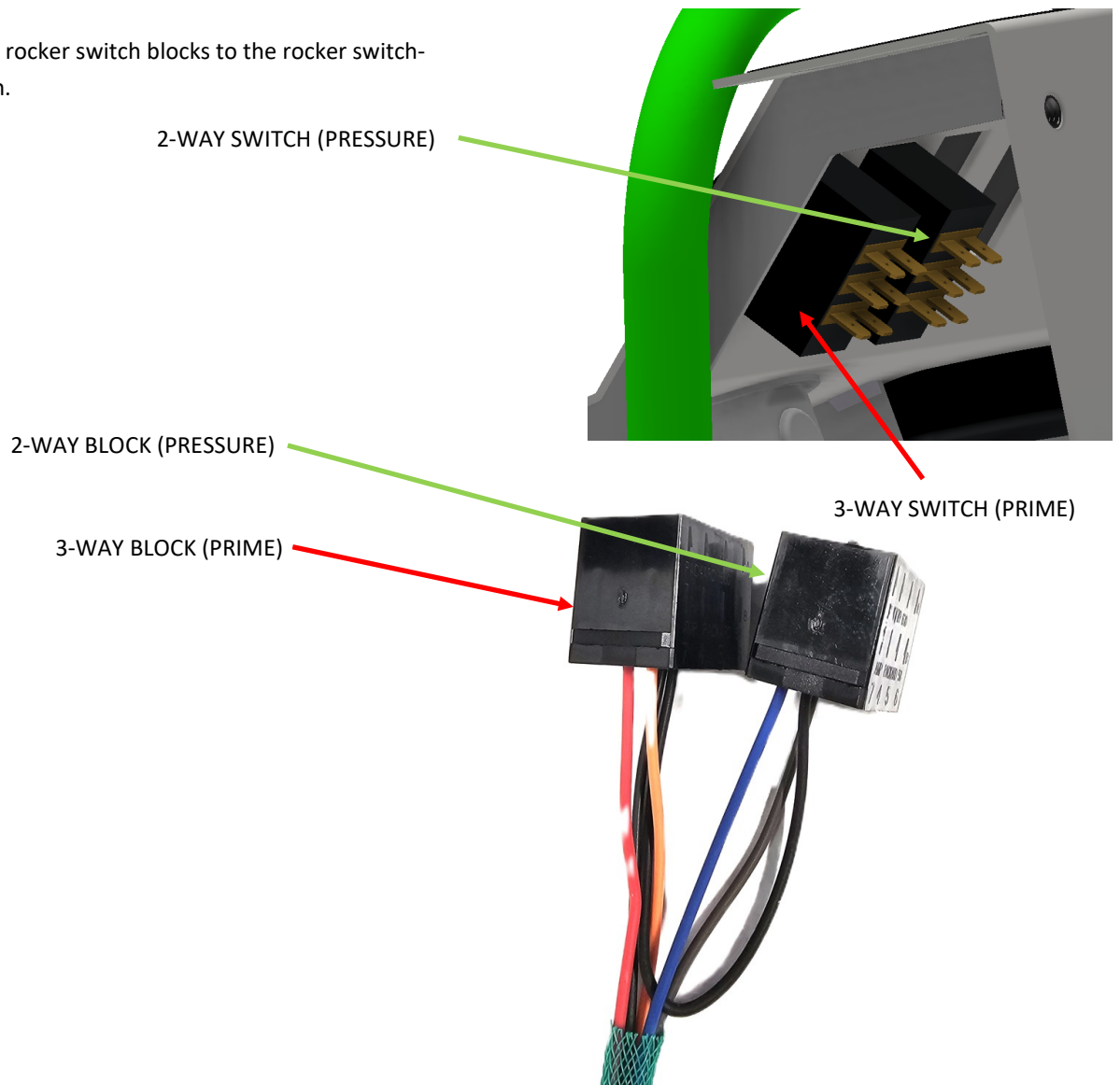

# PRESSURE CONTROL SYSTEM ASSEMBLY INSTRUCTIONS

**STEP 13:** Connect the 4-way plug to the plug on KZ valve assembly.



**STEP 14:** Connect the 2-way sensor plug to the cable on the pressure sensor.



**STEP 15:**

- Disconnect the switch block from the pump switch & (Fig. 1) connect the power plug from the harness to the pump switch terminal block.

*2020 or older machine with this type of connection. Use red and blue connections from the harness to connect in-line to the single wire connection of the pump switch. (Fig. 2).*

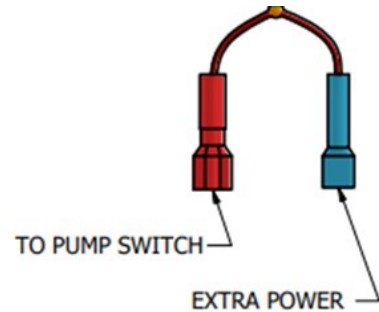

**PUMP SWITCH BLOCK Fig 1**

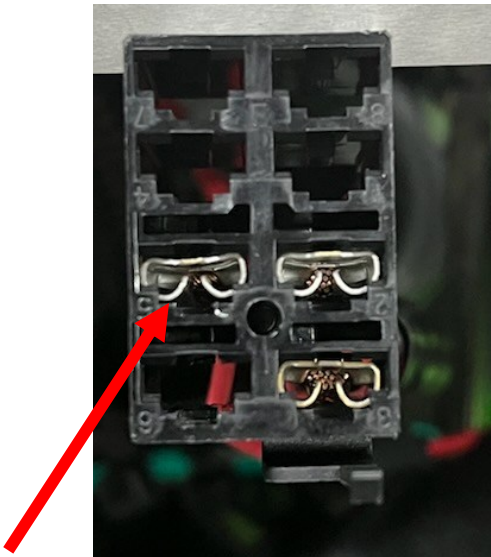

**PUMP SWITCH TERMINAL Fig. 2**



## PRESSURE CONTROL SYSTEM ASSEMBLY INSTRUCTIONS

- Reconnect the block to the pump switch.



**STEP 16:** Connect the ground wire from the harness to the ground block.

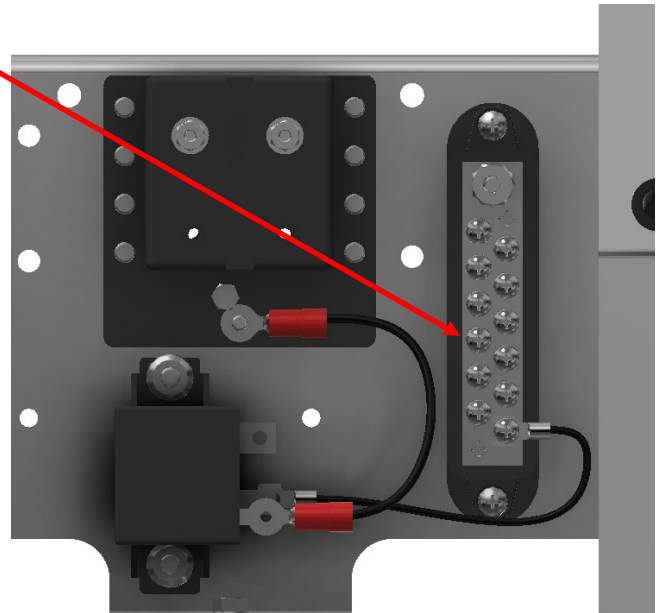

# PRESSURE CONTROL SYSTEM ASSEMBLY INSTRUCTIONS

## STEP 17:

- Reattach the upper panel.

PARTS LIST			
ITEM	QTY	PART NUMBER	DESCRIPTION
11	10	HFSSC-145	HEX FLANGE BOLT, SS - 1/4-20 x 1/2
29	1	R21-079	SG CABLE MOUNT

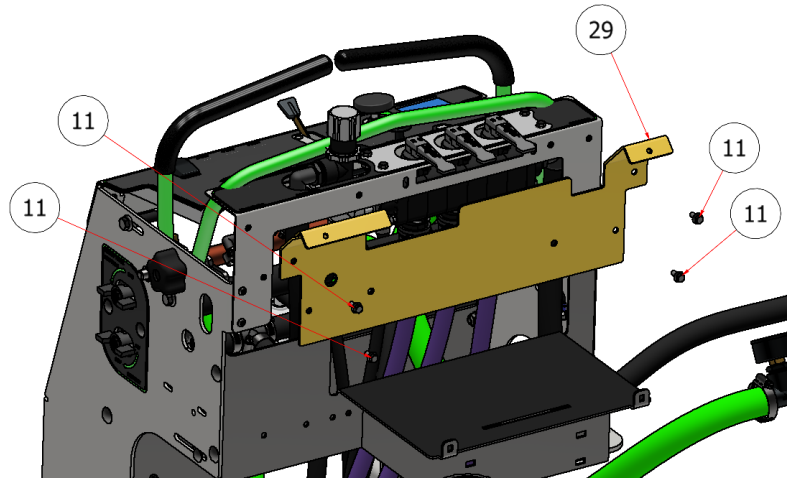

- Reattach the fuel tank support.

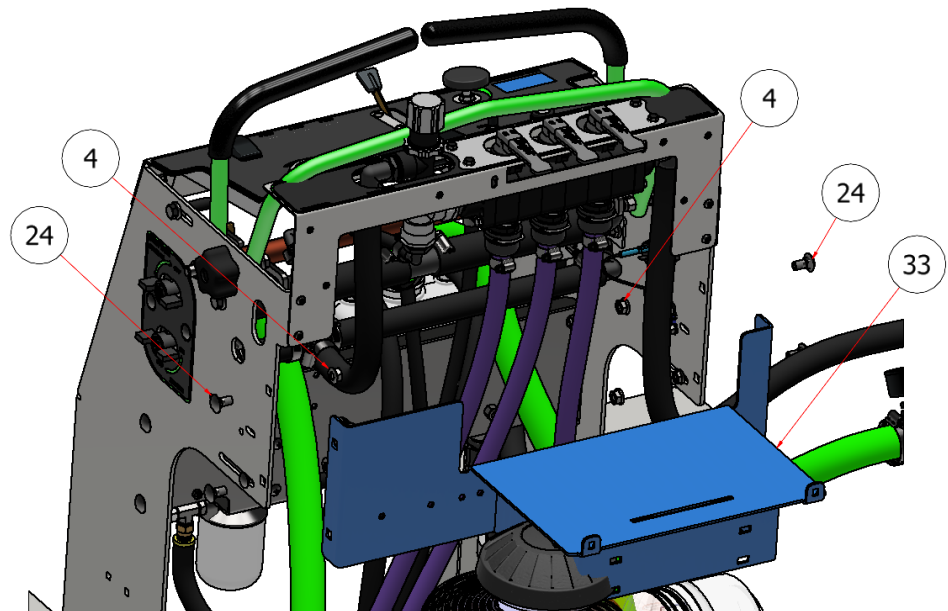

PARTS LIST			
ITEM	QTY	PART NUMBER	DESCRIPTION
4	10	HFNCS-38S	HEX FLANGE NUT, SS - 3/8-16
24	4	CB-3834SS	CARRIAGE BOLT, SS - 3/8-16 x 3/4
33	1	W21-247	FUEL TANK SUPPORT

# PRESSURE CONTROL SYSTEM ASSEMBLY INSTRUCTIONS

## STEP 18:

- Reinstall the fuel tank.
- Squeeze the hose clamp and slide it back.
- Reconnect both fuel lines.

### CAUTION

-Beware of excess fuel in the lines.

-Fuel spillage.

### WARNING

-Flammable gas.

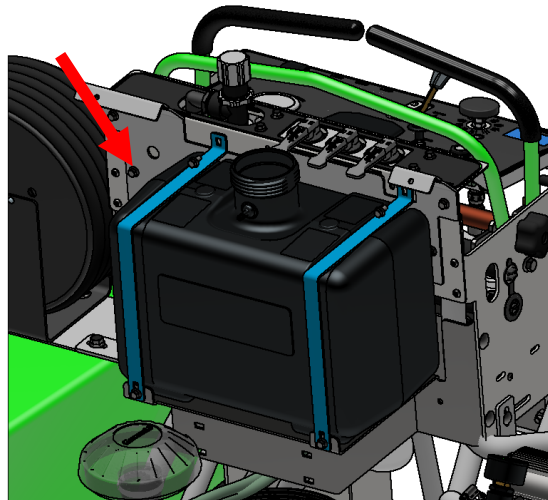

ENGINE SUPPLY LINE

PRESSURE RELIEF



**STEP 19:** Reconnect the battery *power wire* first, and then reconnect the *ground wire*.



# PRESSURE CONTROL SYSTEM ASSEMBLY INSTRUCTIONS

## OPERATION

- Adjust the throttle valve to wide open.
- Turn the spray pump on.
- Set the spray pressure - Increase or decrease the spray pressure by pressing the pressure switch “press +” or “press -”



## NOTICE

*You can increase or decrease the spray pressure one psi at a time by bumping the switch or press and hold the switch + or - to increase or decrease spray pressure.*

- Spray pressure is measured by the pressure gauge.
- Use the **Spray Calibration Chart** to determine the desired spray pressure.
- If the tank is out of liquid, place the prime switch to the “center position” to prime. Once the prime switch is placed back to boom or hose reel, it will return to desired spray pressure.

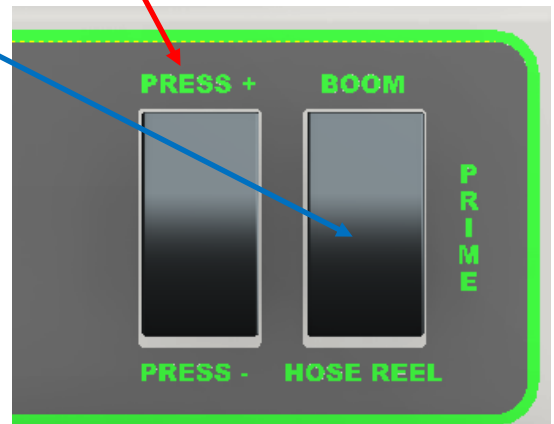
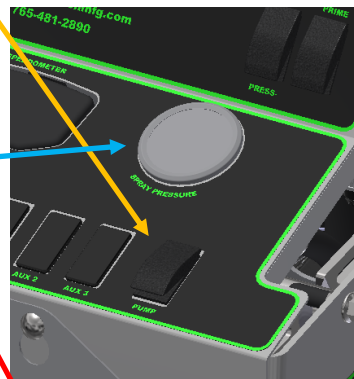

## NOTES

## NOTES

## NOTES



Steel Green Mfg.  
824 S State Road 39  
Lebanon, IN 46052  
(765)-481-2890  
[www.steelgreenmfg.com](http://www.steelgreenmfg.com)

MANUAL PART NO.	MANUAL REV.	DESCRIPTION	KIT PART NO.
SGM-031	C	SG PRESSURE CONTROL SYSTEM	A10058