

STEELGREEN MANUFACTURING™

INSTRUCTION MANUAL

SGXL HOPPER CONTROL REPLACEMENT

Kit Part No. - K10063

Models: SGXL

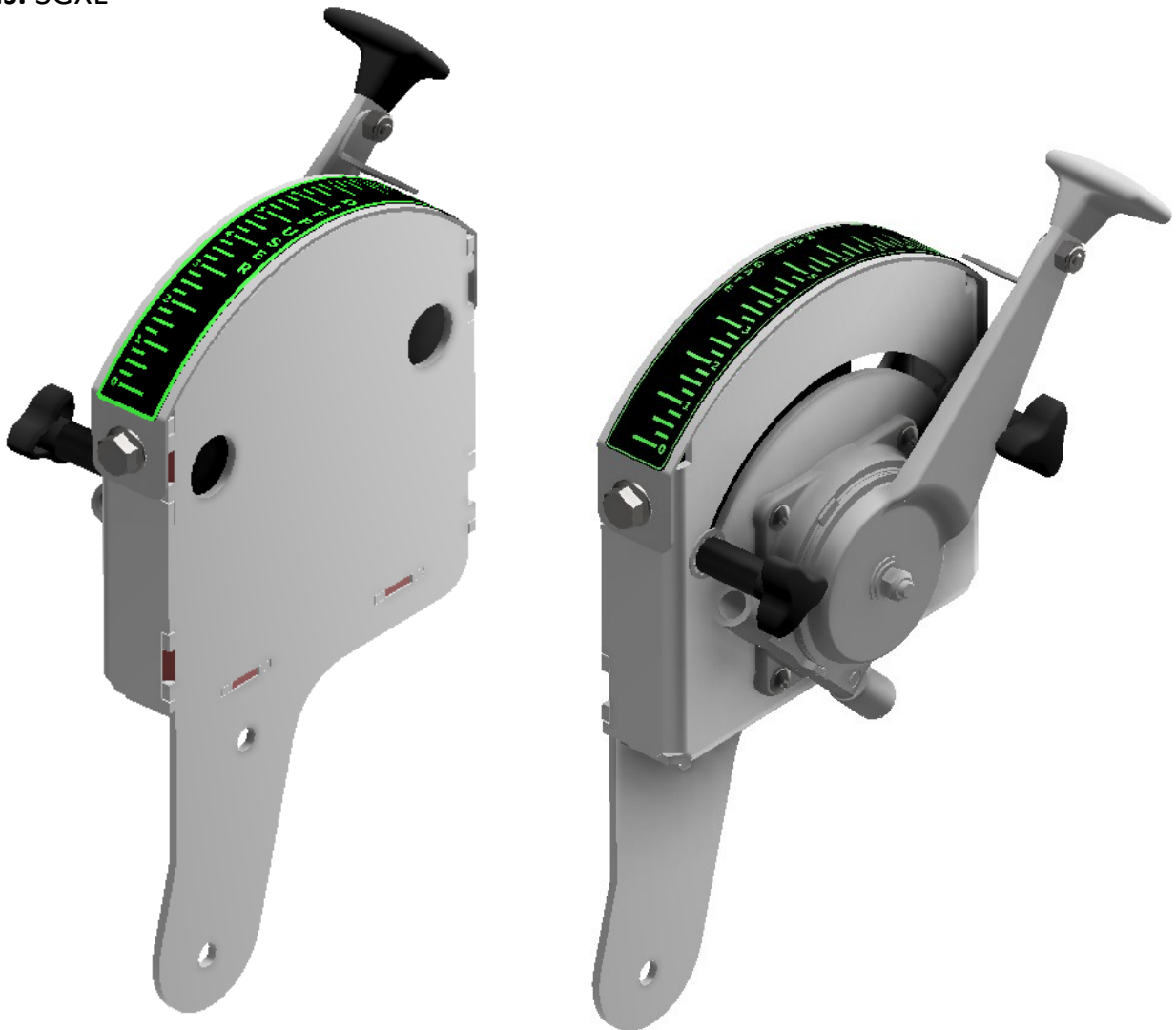

SGXL HOPPER CONTROL REPLACEMENT

STEP 1:

- Disconnect the clevis from the arm.
- Loosen the nuts & remove the cable from the control assembly.

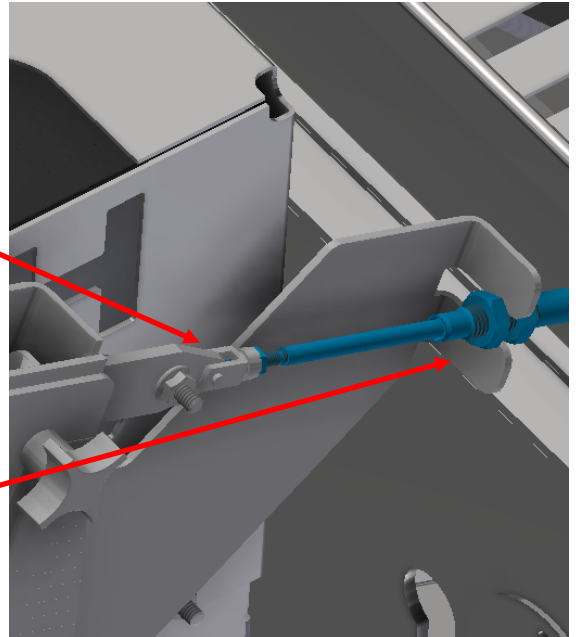

- STEP 2:** Loosen the bolts in the upright & remove the control assembly.

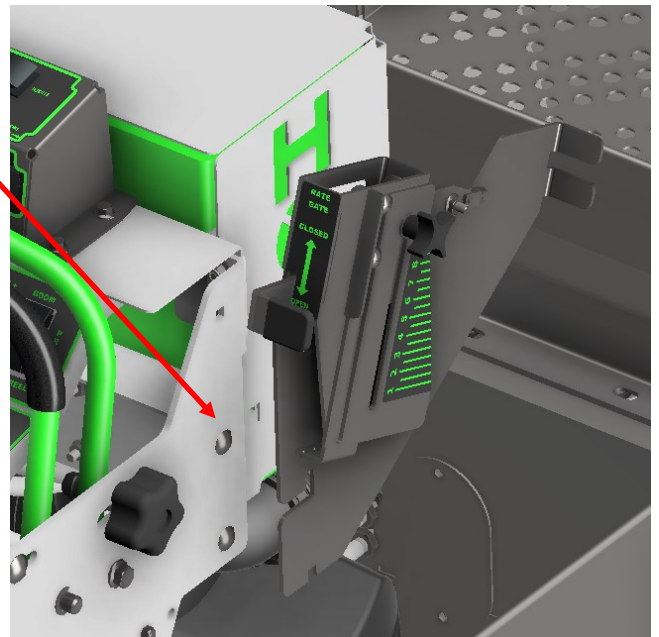

SGXL HOPPER CONTROL REPLACEMENT

STEP 3:

- Disconnect the clevis from the gate plate.
- Loosen the nuts & remove the cable from the hopper panel.

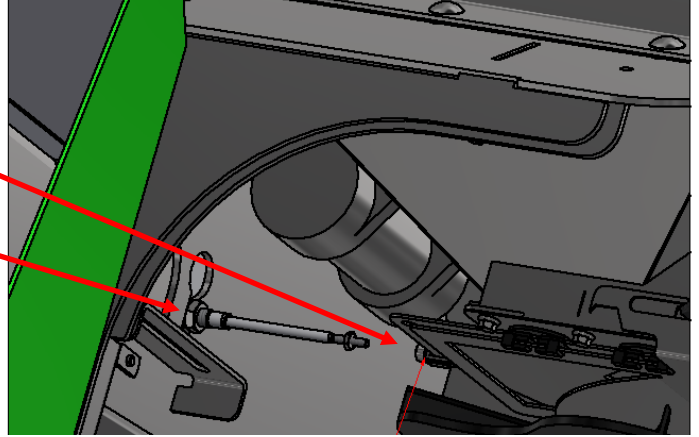

STEP 4:

- Remove the (4) bolts from the hopper motor assembly & rotate the assembly down to clear the gate.

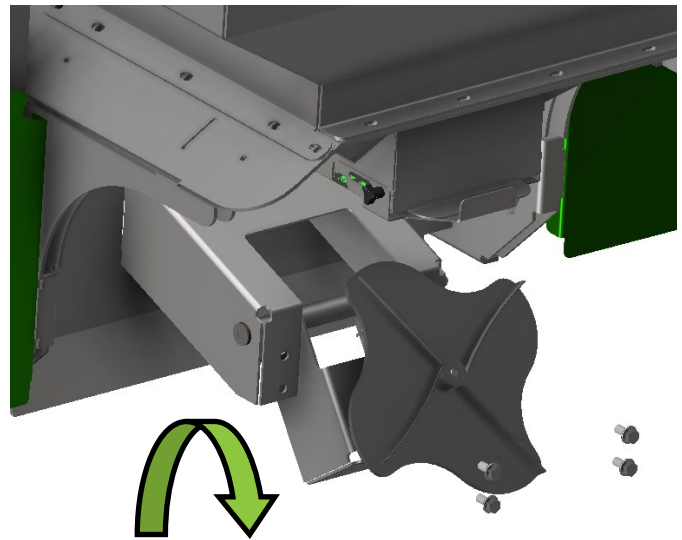

- Remove the knobs & rate gate plate from the hopper tub.

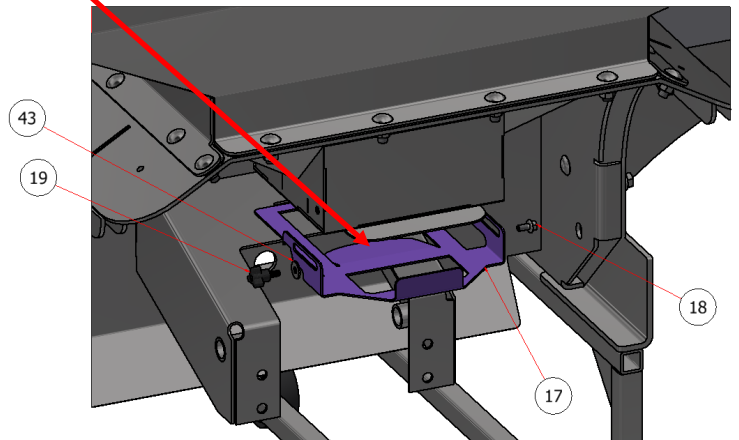

PARTS LIST			
ITEM	QTY	PART NUMBER	DESCRIPTION
17	1	R24-042.1	RATE GATE, XL HOPPER
18	9	HFSSC-145	HEX FLANGE BOLT, SS - 1/4-20 x 1/2
19	1	C60210	PLASTIC KNOB, 1/4"
43	1	FWSS-14	FLAT WASHER, SS - 1/4

SGXL HOPPER CONTROL REPLACEMENT

STEP 5: Remove the diffuser panel from the hopper tub.

PARTS LIST			
ITEM	QTY	PART NUMBER	DESCRIPTION
10	4	D70005	GUIDE, RATE GATE/DIFFUSER
13	1	R24-034	GATE, HOPPER, SGXL

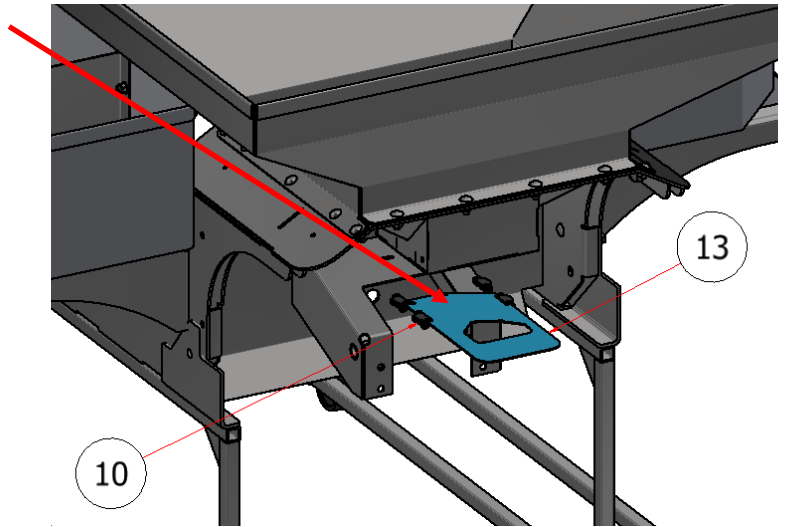

STEP 6: Align the guides with the notches on the bottom of the hopper tub & Attach the assembly provided with the kit to the tub.

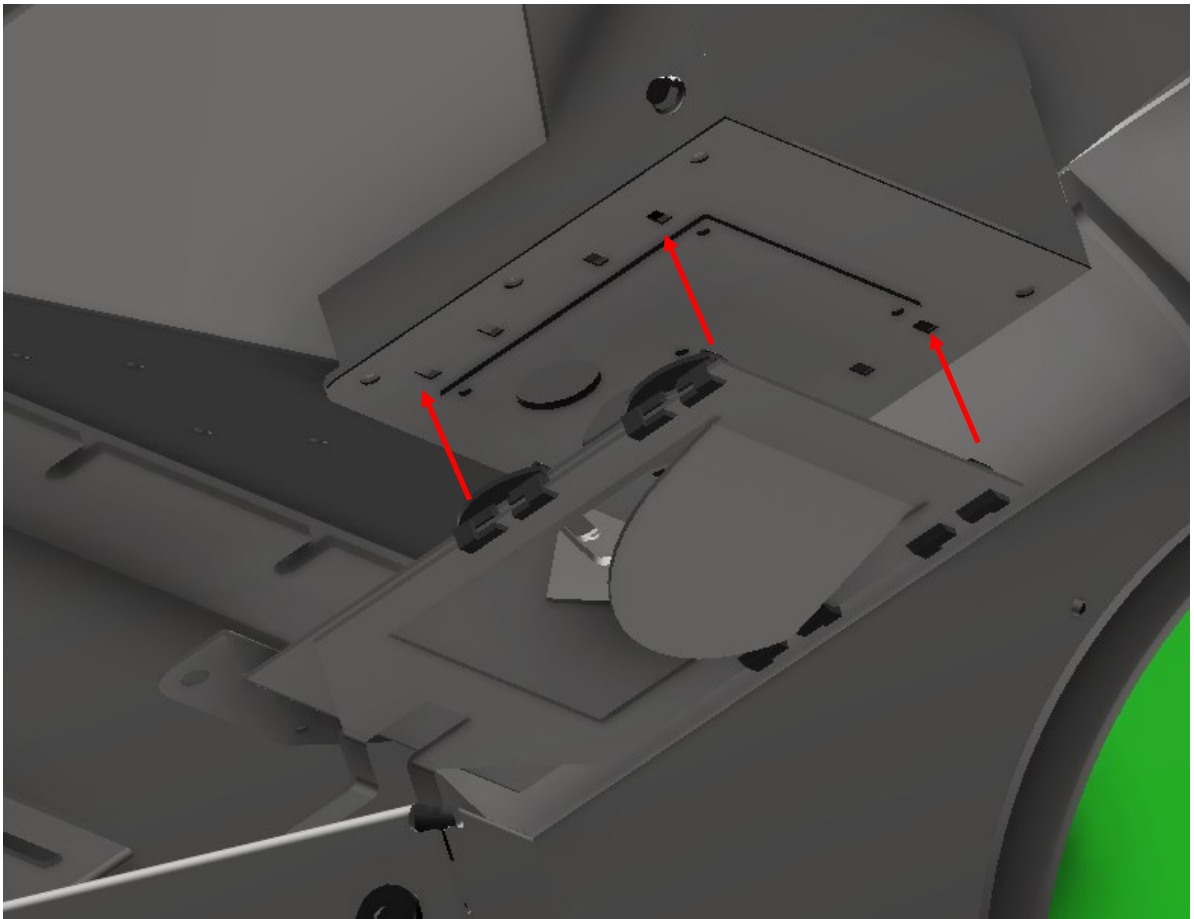

SGXL HOPPER CONTROL REPLACEMENT

STEP 7: Loosen the nuts from the hydraulic tank support & attach the Rate Gate control to the upright *RIGHT SIDE*.

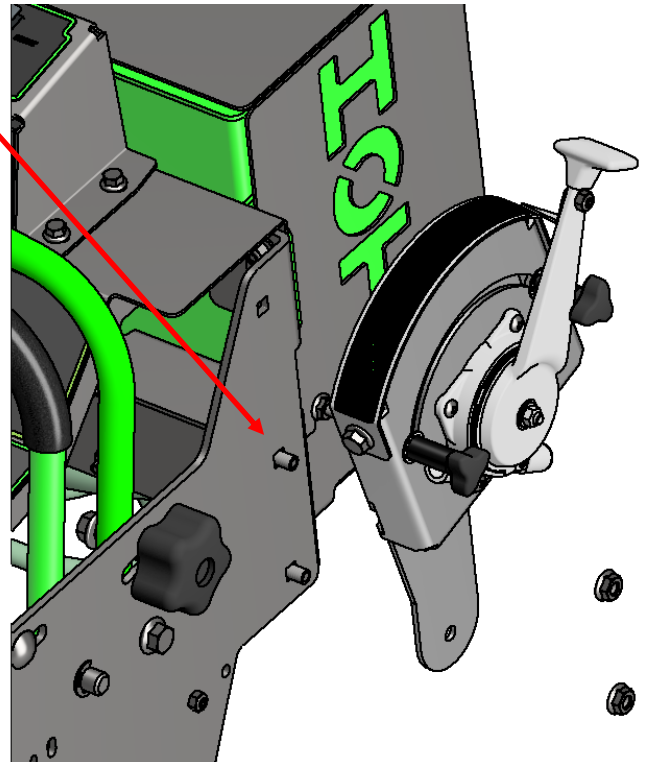

STEP 8: Loosen the nuts from the hydraulic tank support & attach the Diffuser control to the upright *LEFT SIDE*.

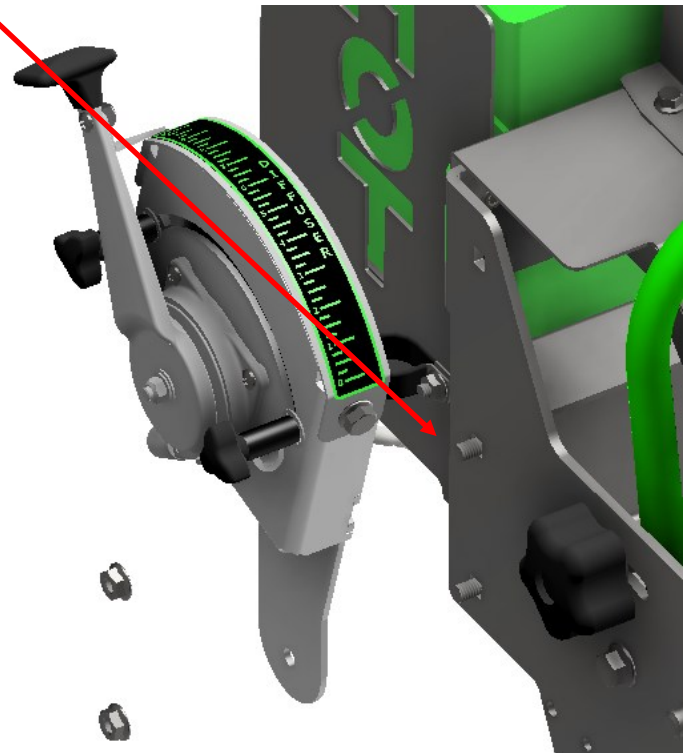

SGXL HOPPER CONTROL REPLACEMENT

STEP 9:

- Pass the *DIFFUSER* cable through the hole in the panel. Leave the cable loose until it's attached to the gate plate.
- Repeat this step for the *RATE GATE* cable.

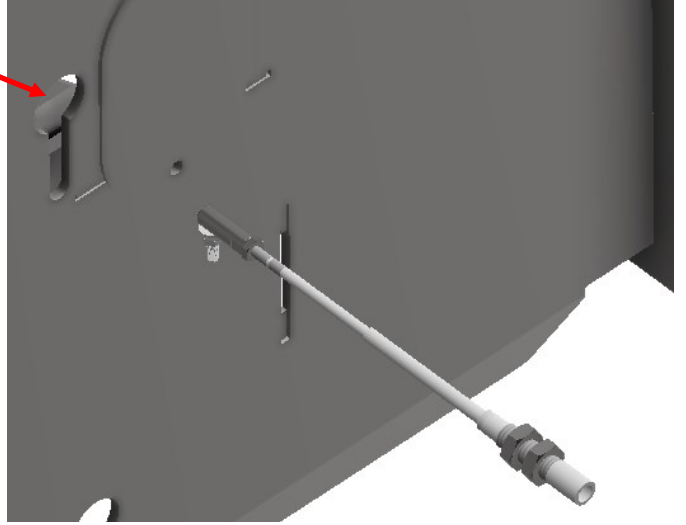

STEP 10: Attach the end of the Diffuser cable to the diffuser plate.

32

PARTS LIST			
ITEM	QTY	PART NUMBER	TITLE
32	2	HFNCS-10S	HEX FLANGE NUT, #10

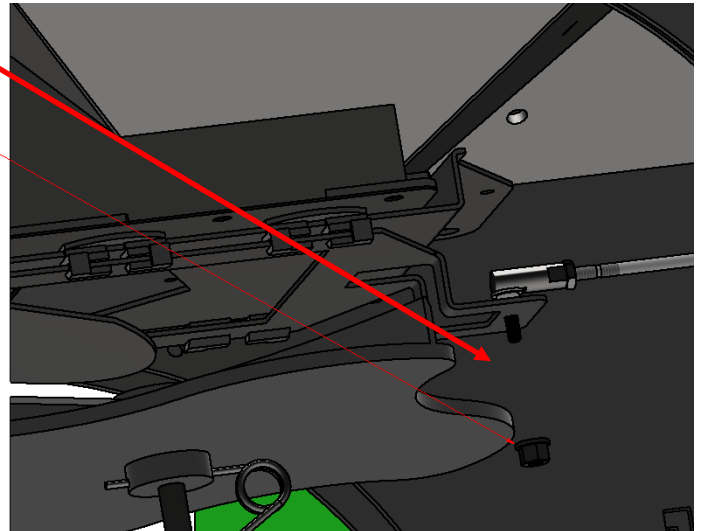

STEP 11: Attach the end of the Rate Gate cable to the displacement plate.

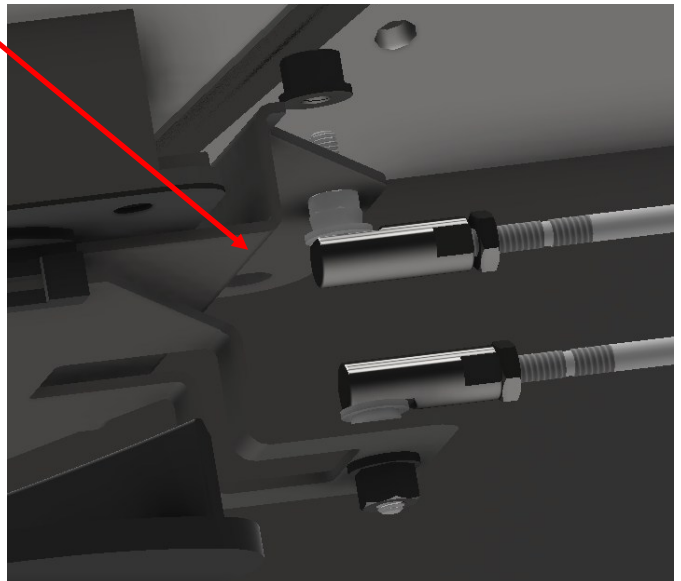

SGXL HOPPER CONTROL REPLACEMENT

STEP 12: Tighten both the cables.

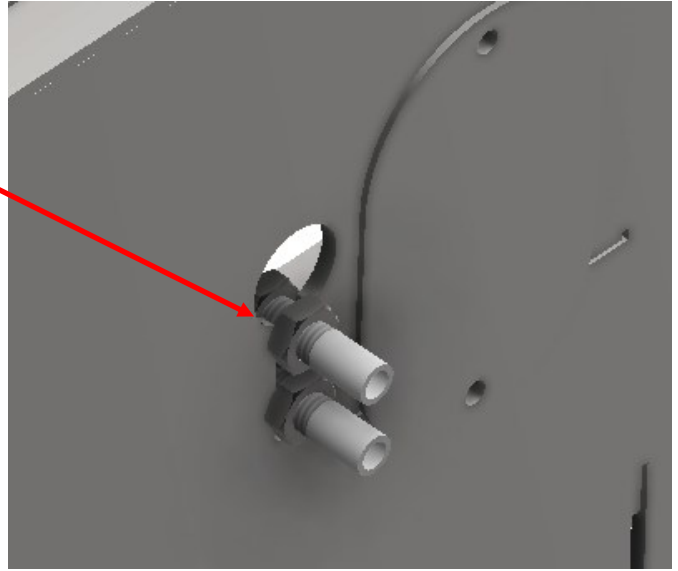

OPERATION

STEP 1:

- Turn the knob on the control valve to adjust the hopper speed.
- Press the switch to activate the agitator

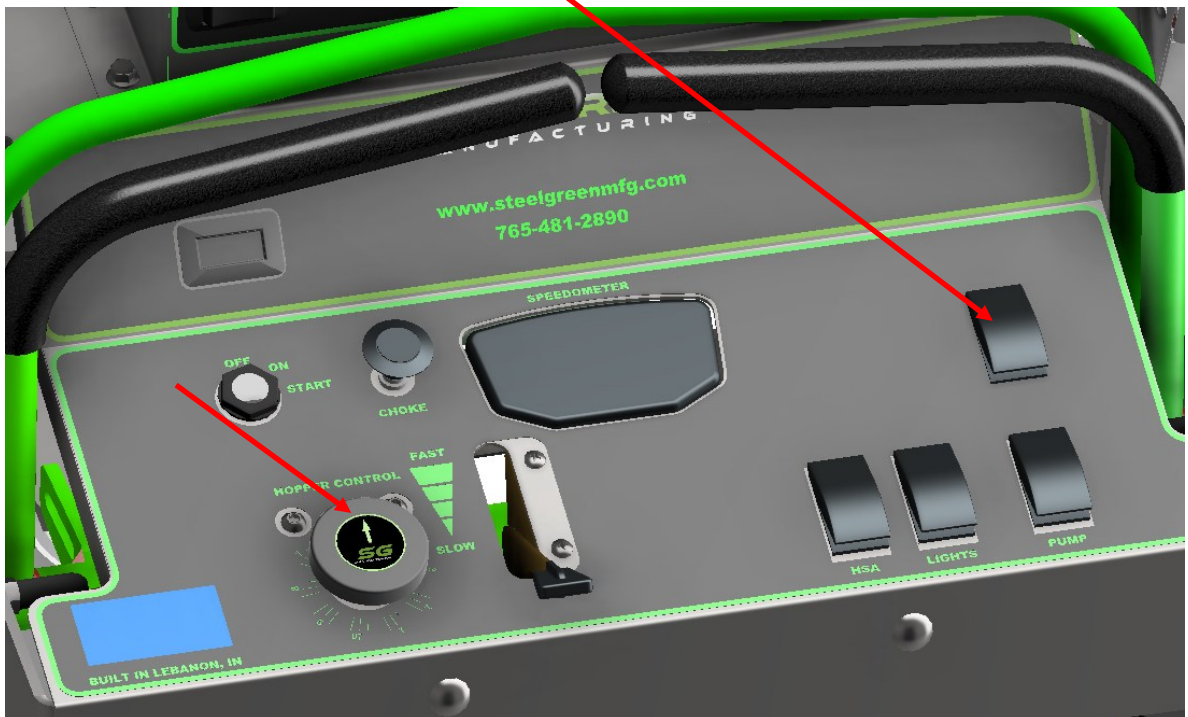

SGXL HOPPER CONTROL REPLACEMENT

STEP 2:

- Increase the granular rate by moving the lever forward.
- Once the desired rate is set, loosen the knobs to move the *lever stops* to mark desired positions.

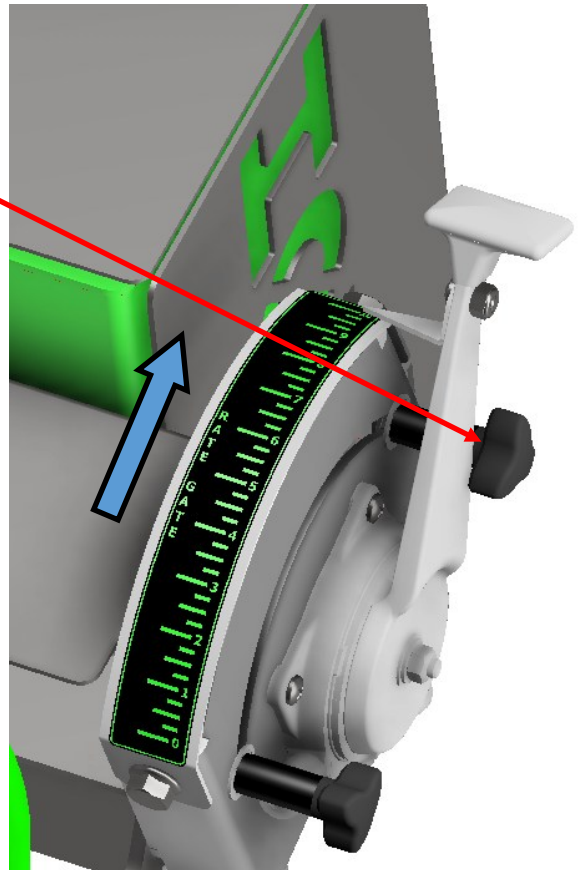

STEP 3:

- Increase the diffuser by moving the lever forward.
- Once the desired position is set, loosen the knobs to move the *lever stops* to mark desired positions.

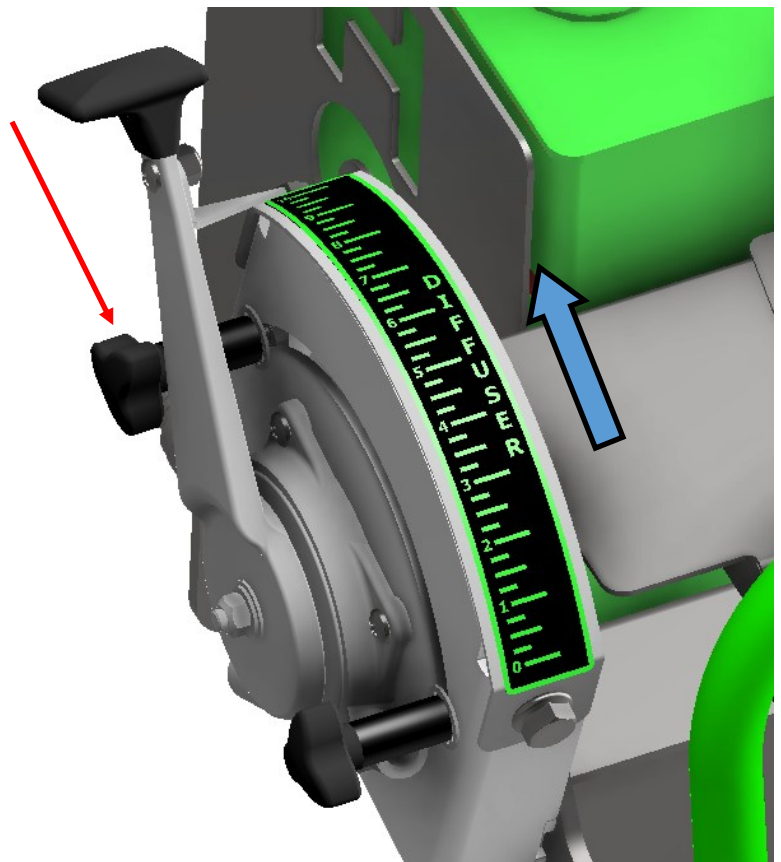

NOTES

NOTES

NOTES



Steel Green Mfg.
824 S State Road 39
Lebanon, IN 46052
(765)-481-2890
www.steelgreenmfg.com

MANUAL PART NO. -SGM-0055
REV. 1