

STEELGREEN[™]

M A N U F A C T U R I N G

INSTRUCTION MANUAL

HYDRAULIC LIFT ATTACHMENT

Models: SG36, SG42, SG46, & SG52



HYDRAULIC LIFT INSTRUCTIONS

STEP 1:

- Set the hydraulic lift in the frame by resting the front of the lift on top of the frame rail and the back of the lift will attach to the bottom of the frame rail.

TIP

Use a floor jack or block of wood to support the back of the lift.

- Attach the hydraulic lift to the frame using the top brackets and (6) CB-375275 3/8" X 2-3/4" carriage bolts and (6) SSNNC-38 3/8" nuts provided with the kit.

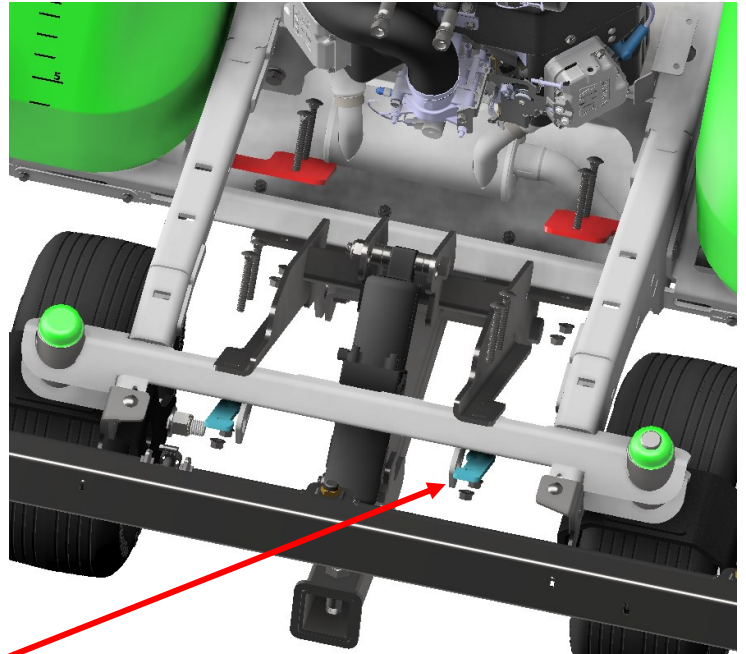

R22-235 FRONT BRACKET

NOTICE

Note the orientation of the back brackets. Be sure the tab is facing the correct direction (One will face left and the other will face right) so the hitch is centered in

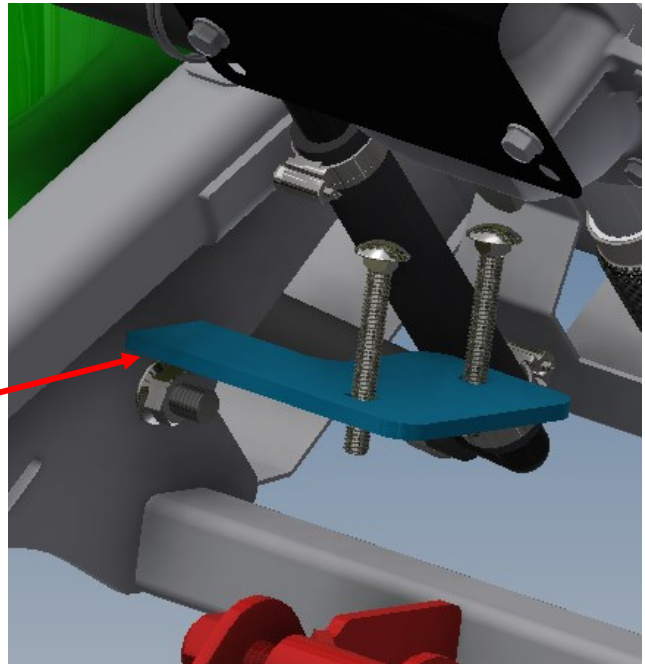

R22-234 REAR BRACKET

HYDRAULIC LIFT INSTRUCTIONS

STEP 2:

- Remove the existing (2) bolts from the gas tank support.

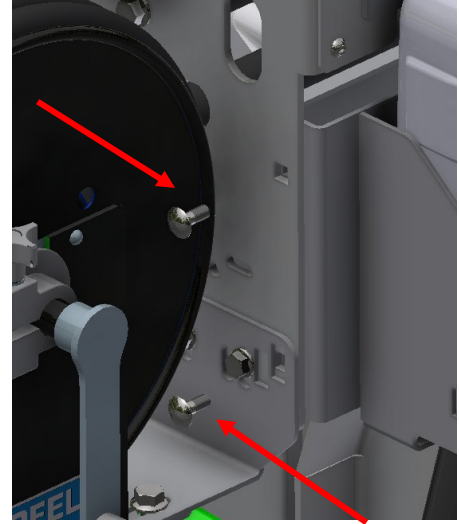

- Attach the control valve assembly to the side of the upright using (2) 3/8 X 1" carriage bolts provided with the kit and reuse the nuts that were removed.

NOTICE

- *If your machine is equipped with an "all liquid" tank and is the Steel Green current design (Fig.1) the valve assembly can be flipped to allow the control valve to be mounted.*
- *If your machine is equipped with the old valve design, you can purchase the updated brackets.*

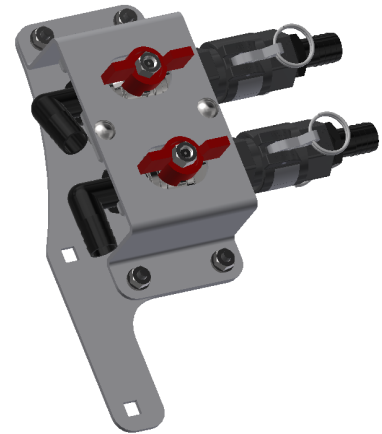
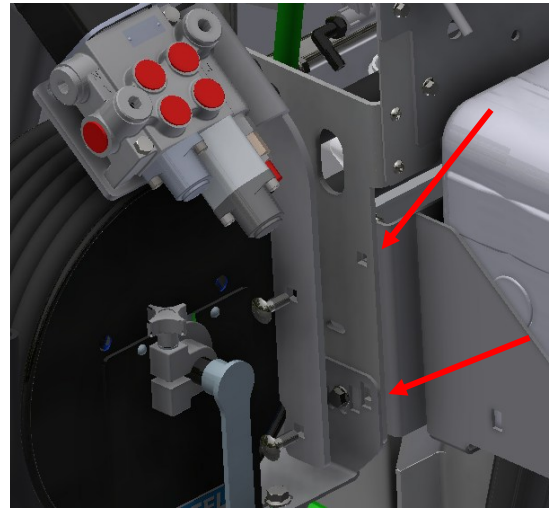

Fig. 1

HYDRAULIC LIFT INSTRUCTIONS

NOTICE

Before starting the following steps, drain the hydraulic oil from the machine. Refer to Steel Green Hydraulic oil change manual.

⚠ WARNING

Connecting the hoses incorrectly will blow the seals out of the snow plow valve & void the Steel Green Warranty.

STEP 3:

- Locate the hose that runs from the bottom port of the hopper control valve down to the left pump.
- Disconnect each end of the hose and use the (2) 1/4" jic red plugs provided with the kit to cap the ends of the hose.

NOTICE

Leave the hose zip tied in the bundle and tuck the ends out of the way.

TIP

Disconnect the end from the hopper control valve first and hold the end of the hose up to prevent excess oil spillage. Then turn the end down into a container to drain the rest of the excess oil. Have a rag and or container ready to catch excess oil.

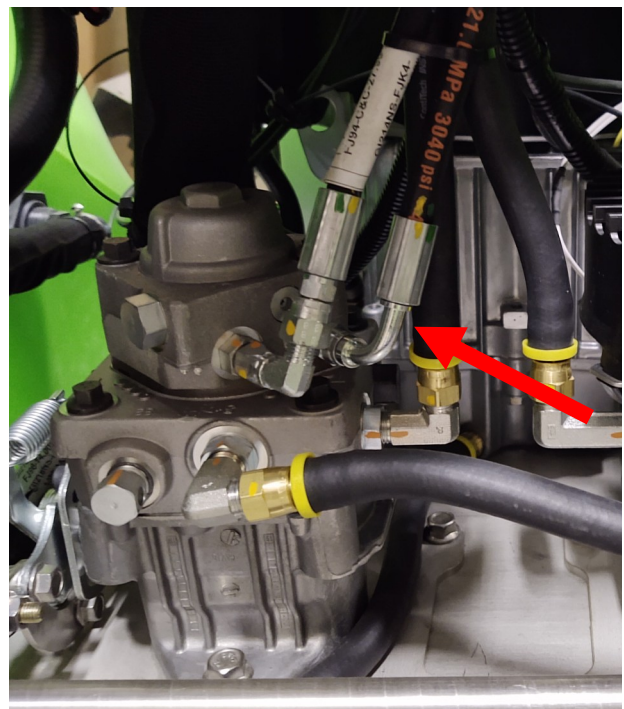
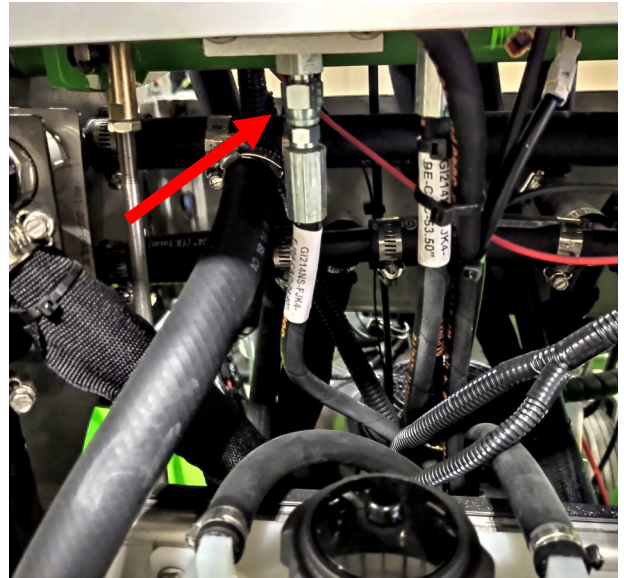

HYDRAULIC LIFT INSTRUCTIONS

NOTICE

If the machine is equipped with a Hill Side Assist attachment, proceed to step 6.

STEP 4:

- Using (1) of the 38" hoses provided with the kit, connect the end with the straight fitting to the return port of the control valve.

A

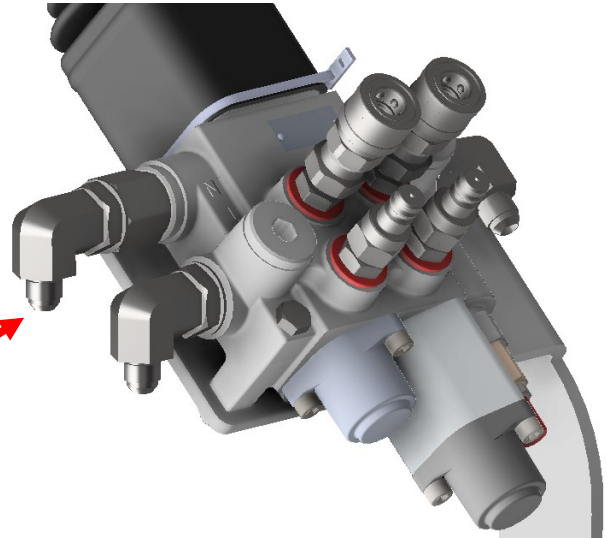

- Connect the other end of the hose to the input port of the hopper control valve. (end with 90° fitting)

A

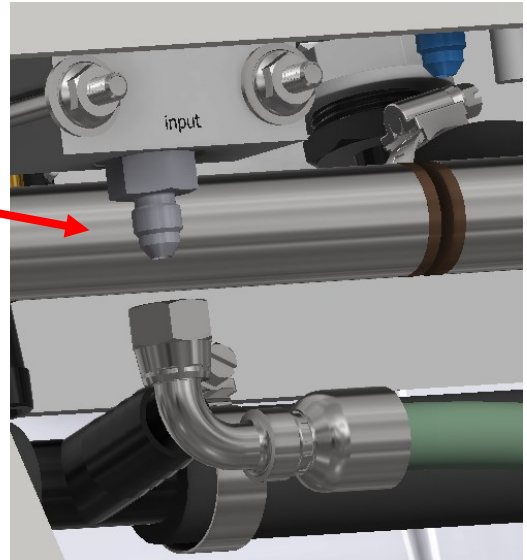

STEP 5:

- Using the other 38" hose provided with the kit, connect the end with the straight fitting to the supply port of the control valve.

B

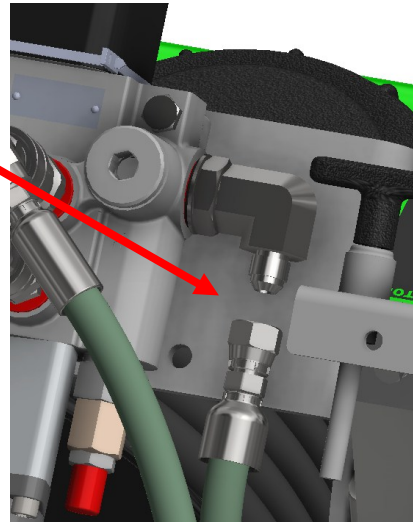

HYDRAULIC LIFT INSTRUCTIONS

- Connect the other end of the hose to the hydraulic pump. (*end with 90° fitting*)

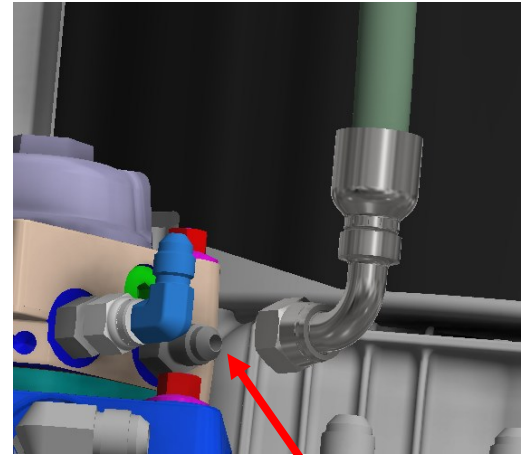

B

NOTICE

- *Secure all hoses with 3/8" hose clamps.*
- *Complete this step for standard machines.*
- *Start here if equipped with HSA attachment.*

STEP 6:

- Locate the *left side* return hose to the tank & cut the hose leaving approx. 5" attached to the tank.

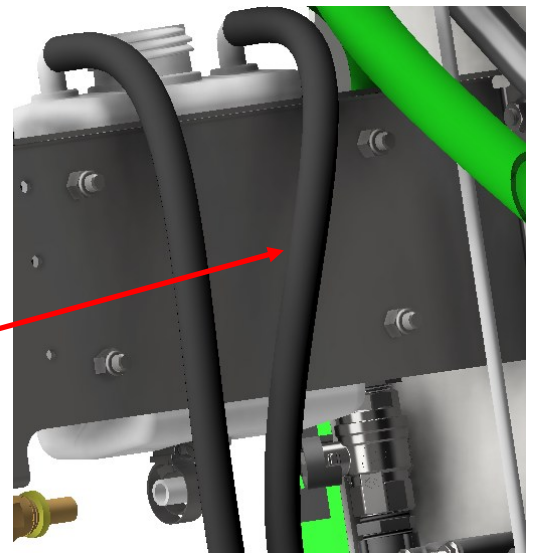

HYDRAULIC LIFT INSTRUCTIONS

- insert the (H80434) brass barb tee fitting connecting the 2 hoses.

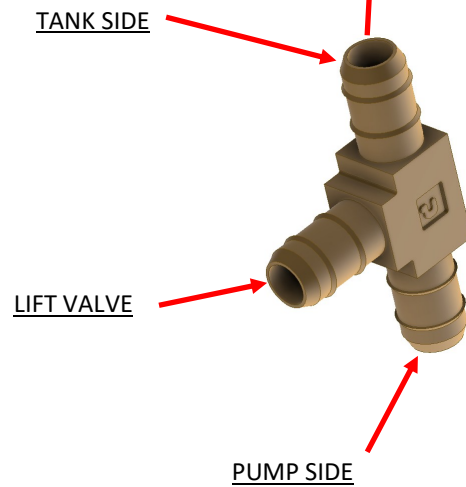
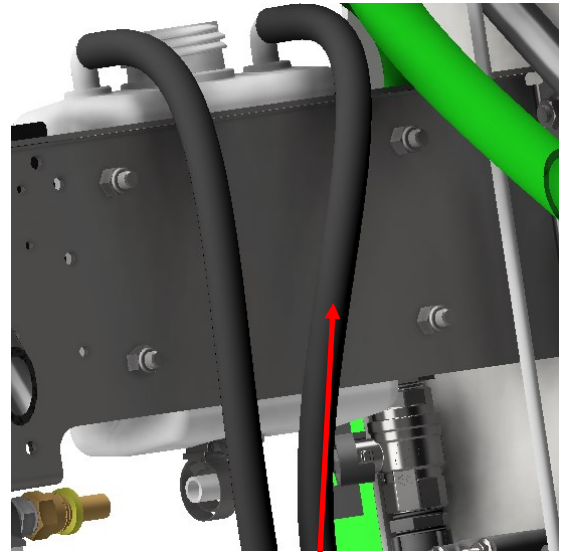

- Connect the hose to the bottom fitting on the lift valve.

- Connect the other end to the brass barb tee fitting.

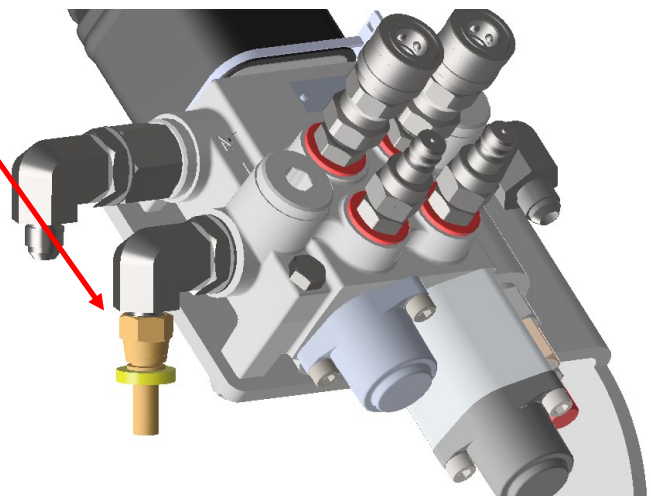

HYDRAULIC LIFT INSTRUCTIONS

STEP 7: (HSA)

- Using the other 38" hose provided with the kit, connect the straight end to the outlet port on the plow control valve.
- Connect the other end to outlet port of the aux. pump.

A

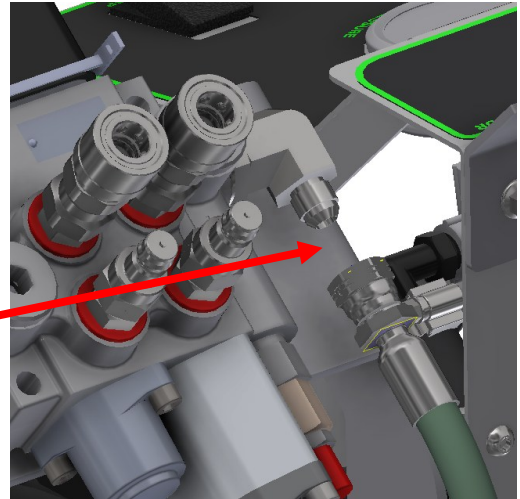

A

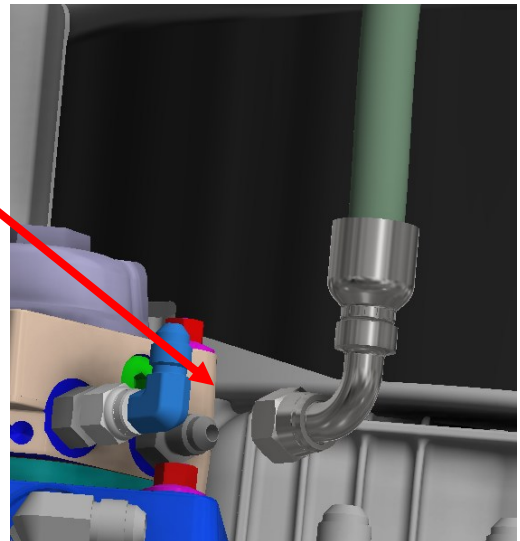

STEP 8: (HSA)

- Connect the straight end of the supplied 3/8" hose to the lift valve.

B

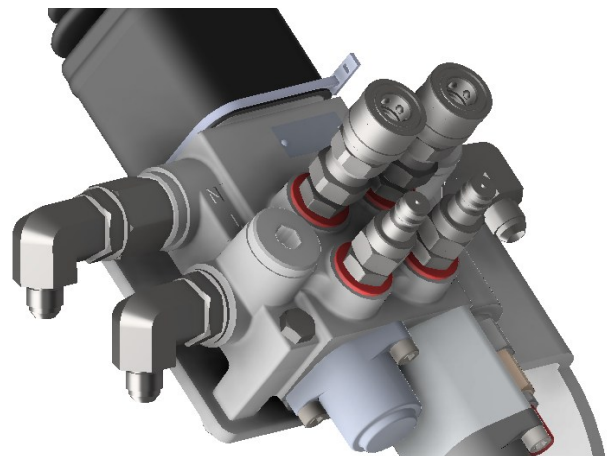

HYDRAULIC LIFT INSTRUCTIONS

- Connect the other end to the tee fitting on the inlet port of the hopper control valve.

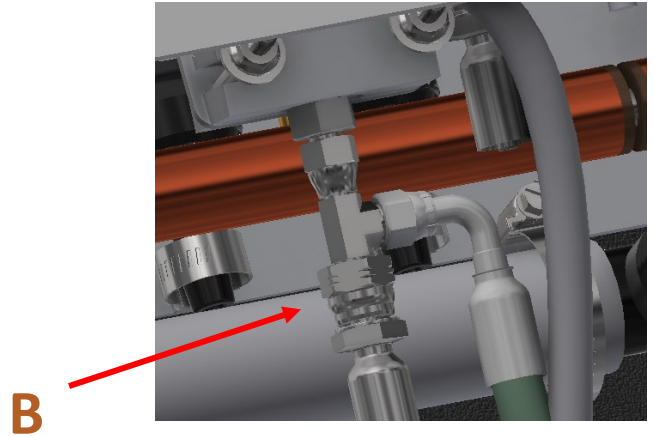

STEP 9: (HSA)

- Connect the straight end of the supplied 3/8" hose to the outlet port of the hsa valve.

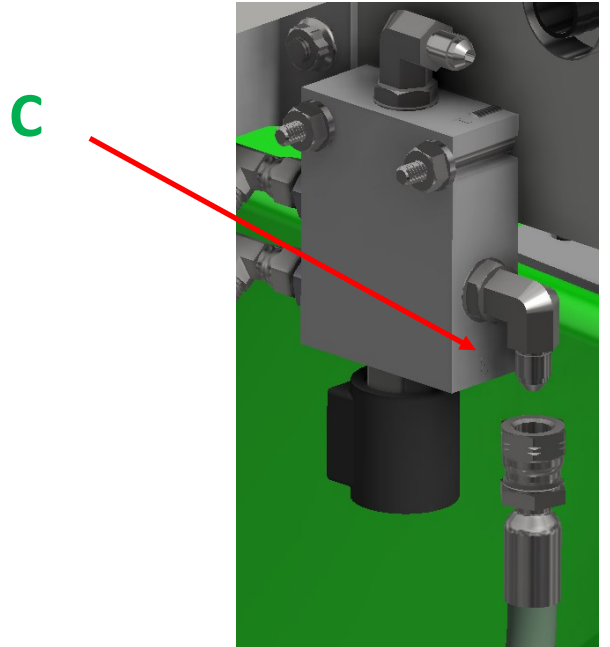

- Connect the other end to the tee fitting on the return port of the aux. pump.

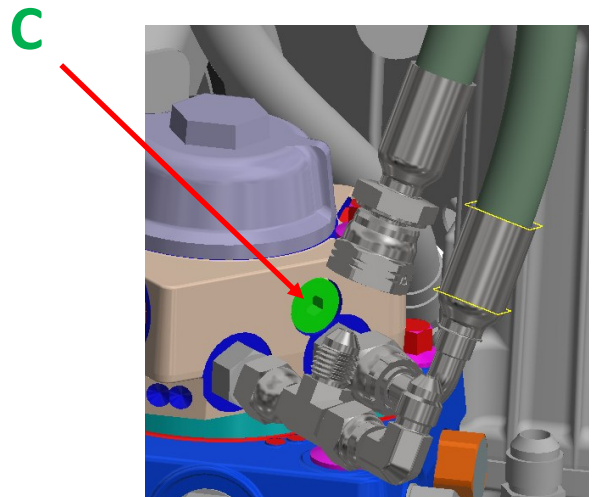

HYDRAULIC LIFT INSTRUCTIONS

STEP 7:

- Top off the hydraulic oil tank and start the machine.
- Operate the plow left/right and up/down.

NOTICE

The cylinders and control valve are empty so it will take a few cycles to fill them and get the air out of the system.

- Top off the oil tank as it gets low, it should take approx. (2) quarts.

CAUTION

DO NOT let the machine run out of hydraulic oil.



NOTES



Steel Green Mfg.
824 S State Road 39
Lebanon, IN 46052
(765)-481-2890
www.steelgreenmfg.com

MANUAL PART NO.	REV.	DESCRIPTION	KIT PART NO.
SGM-040	3	SG HYDRAULIC LIFT ATTACHMENT	K10081