

INSTRUCTION MANUAL

2.5 GALLON FOAM MARKER ATTACHMENT

Models: SG36, SG42, SG46, & SG52

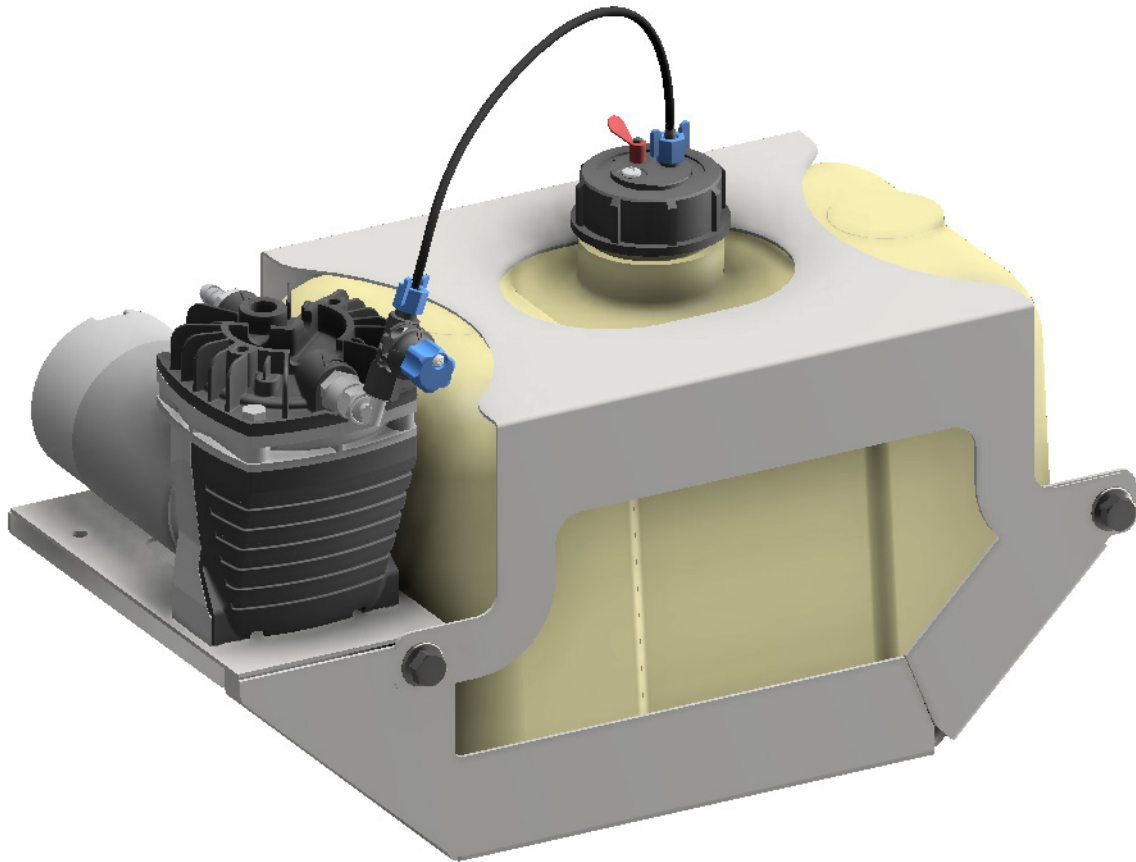

2.5 GALLON FOAM MARKER INSTALLATION

STEP 1: Disconnect the battery, *ground first & then power cable.*



GROUND

POWER

ENGINE SUPPLY HOSE

PRESSURE RELIEF

STEP 2:

- Squeeze the hose clamp & slide it back & disconnect the fuel supply hose.
- Disconnect the pressure relief hose.
- Remove the fuel tank.



CAUTION
Beware of excess fuel in the hoses & fuel spillage.

WARNING
Flammable gas.

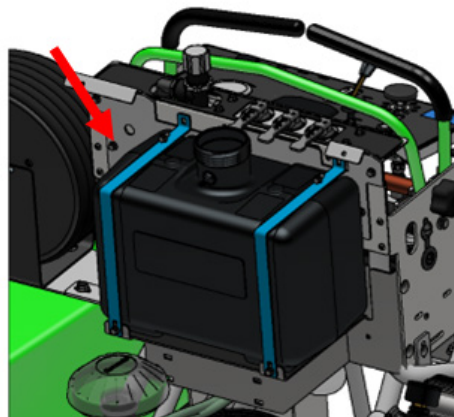

2.5 GALLON FOAM MARKER INSTALLATION

STEP 3:

- (HOPPER) Attach the lower support bracket to the side of the hopper using the diffuser bracket bolts.

PARTS LIST			
ITEM	QTY	PART NUMBER	TITLE
2	1	R22-112	SG FOAM MARKER SUPPORT

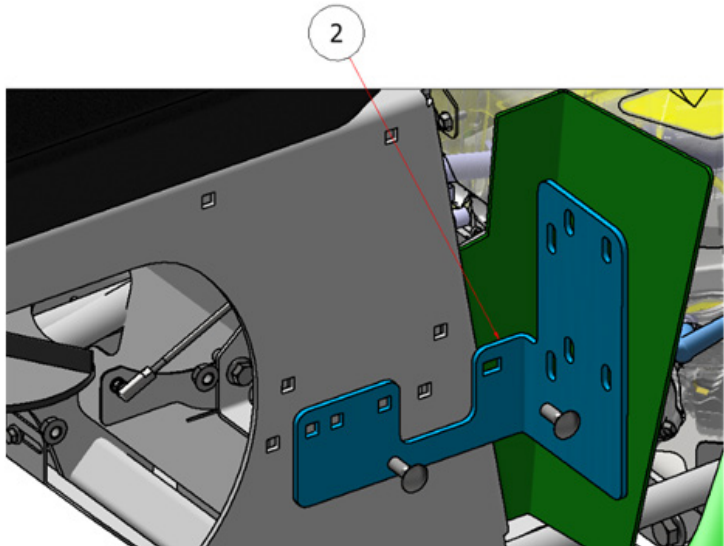

- (35 GALLON TANK) Attach the lower support bracket to the back of the 35 gallon tank frame with 3/8" X 1" carriage bolts.

35 GALLON TANK LOWER SUPPORT (R22-159)

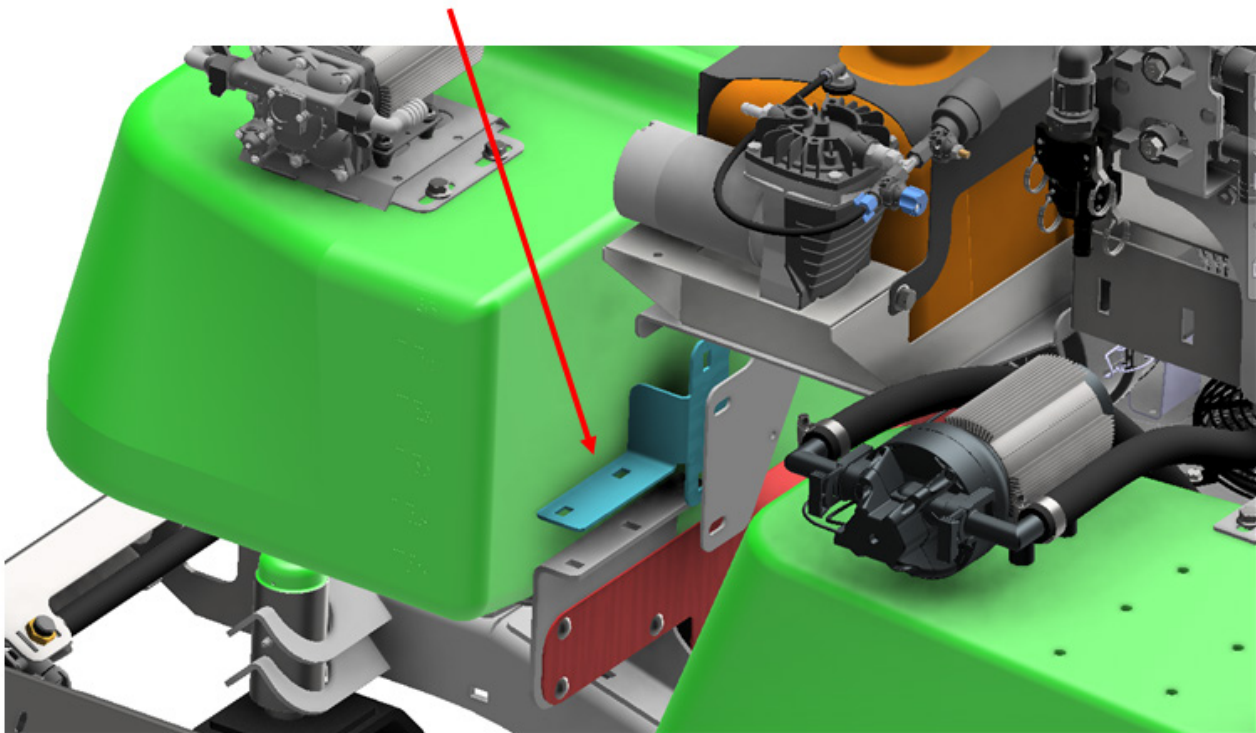

2.5 GALLON FOAM MARKER INSTALLATION

STEP 4: Attach the upper support bracket to the lower bracket & fuel tank support.

PARTS LIST			
ITEM	QTY	PART NUMBER	TITLE
1	1	R22-060	SG FOAM MARKER MOUNT
7	4	CB-3834SS	CARRIAGE BOLT, SS - 3/8-16 x 3/4
8	2	HFNC3-38S	HEX FLANGE NUT, SS - 3/8-16
9	2	CB-1434	CARRIAGE BOLT, 1/4 X 3/4
10	2	HFNC3-25S	HEX FLANGE NUT, 1/4

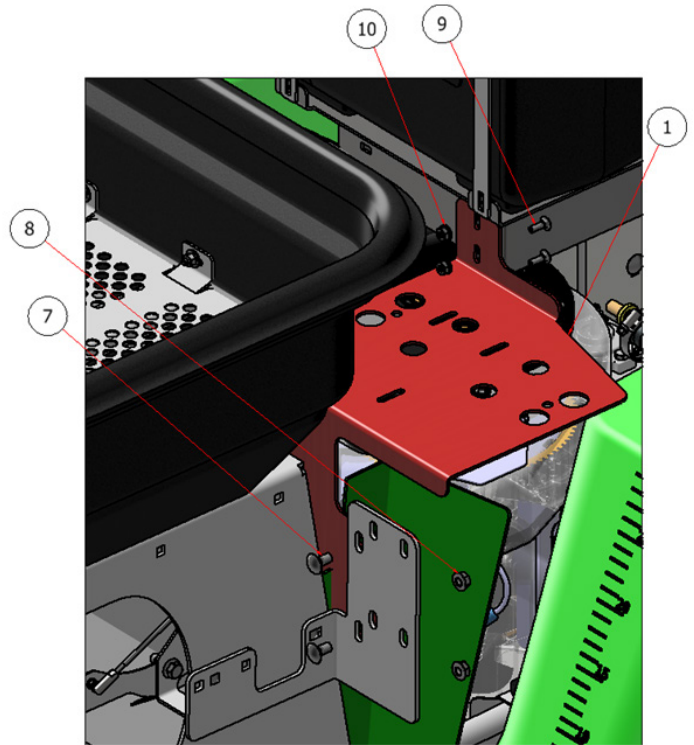

STEP 5: Attach the fm assembly to the support bracket.

PARTS LIST			
ITEM	QTY	PART NUMBER	TITLE
17	2	HFNC3-14SS	HEX FLANGE NUT, 1/4-20

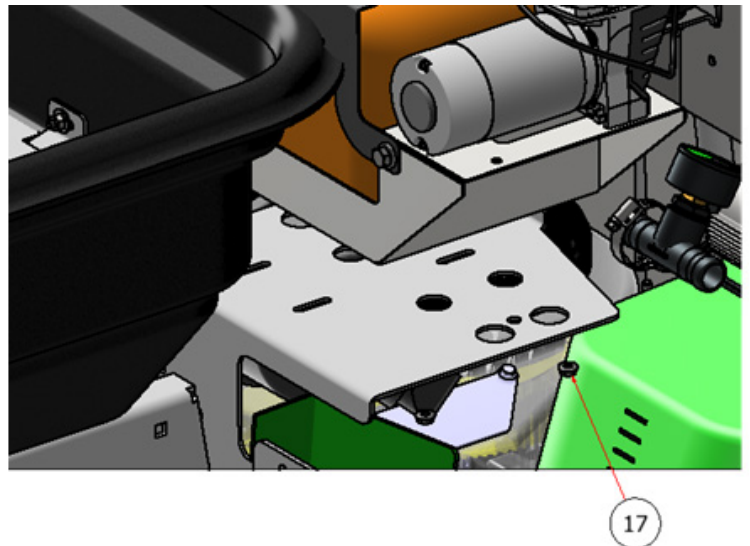

2.5 GALLON FOAM MARKER INSTALLATION

STEP 6:

- Connect one end of the 3/8" hose to barb fitting on the motor.

A

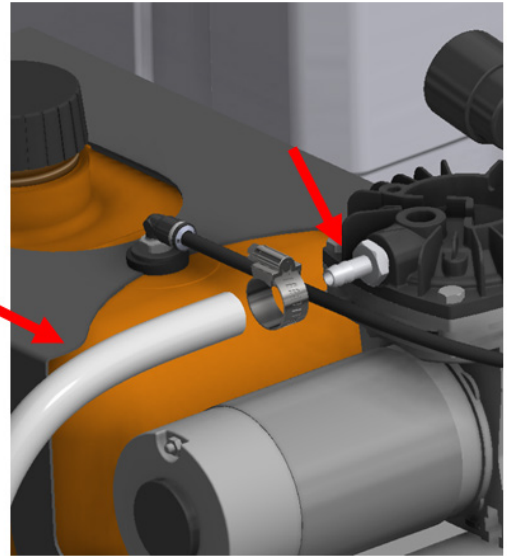

- Route the hose down and along the inside of the hopper.
- Zip tie the hose to the front support bracket.

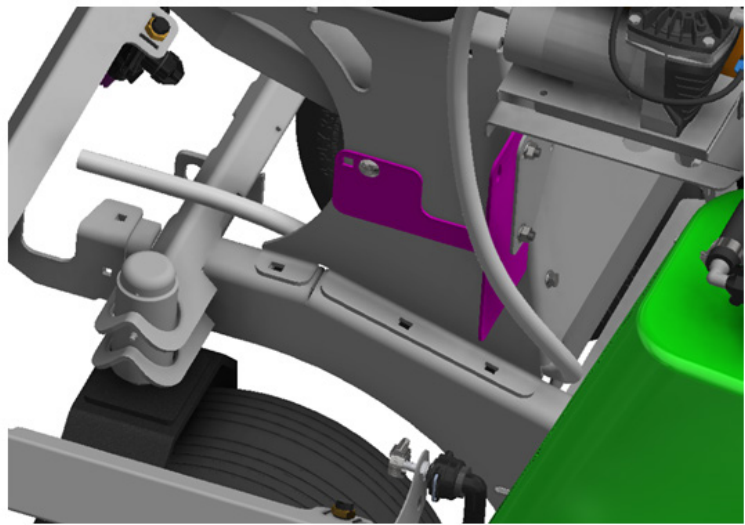
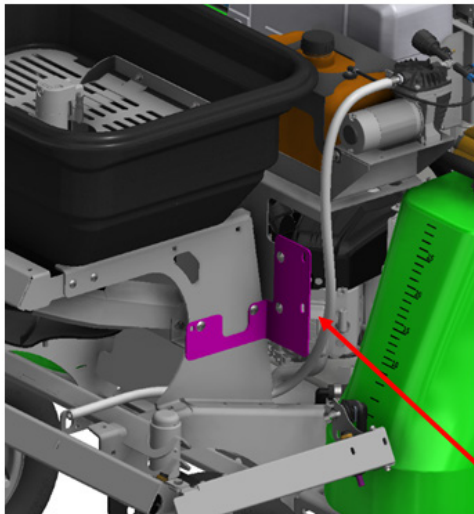

ZIP TIE

2.5 GALLON FOAM MARKER INSTALLATION

STEP 7: Connect the other end of the 3/8" hose to the barb tee fitting.

A

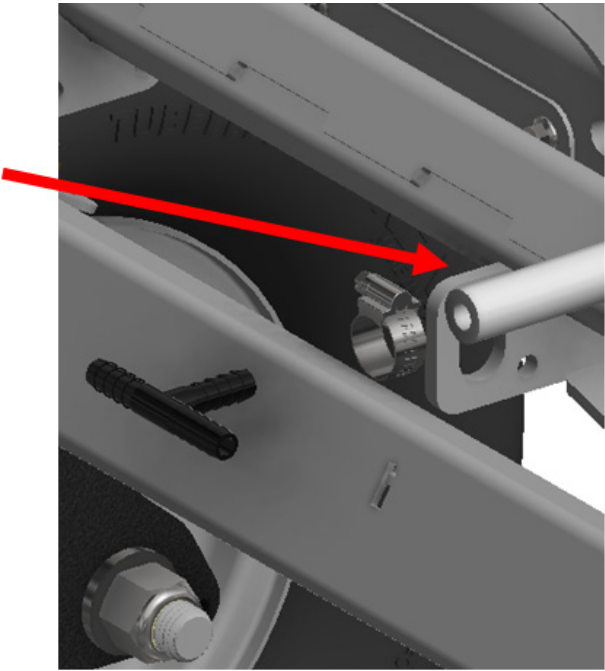

STEP 8: Attach the foam marker bracket to the end of the boom. *SEE FIG. 1 FOR 6 NOZZLE BOOM.*

NOTICE

- Repeat this step for the other side.
- Note the orientation of the bracket for left & right side.

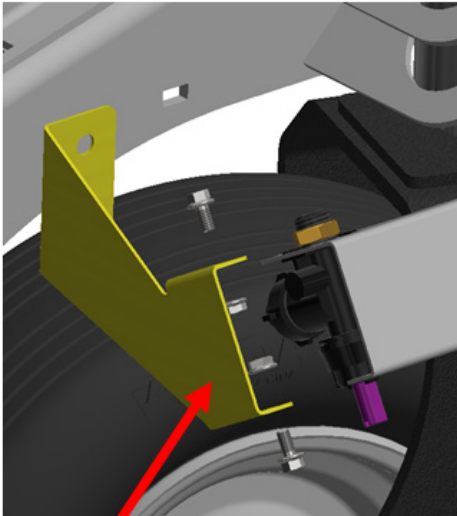

RIGHT SIDE

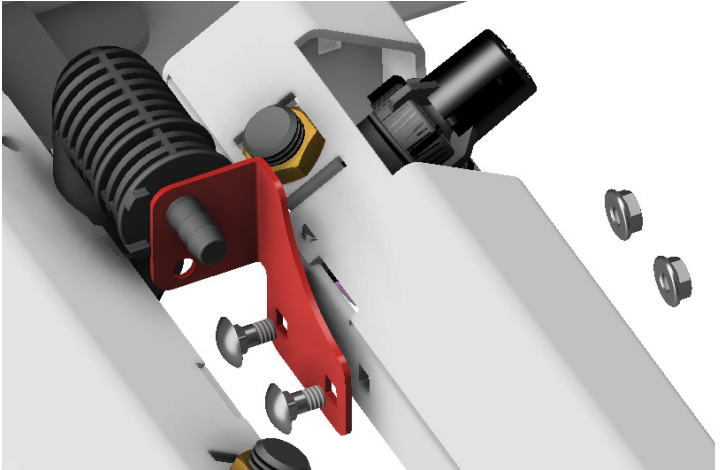

6 NOZZLE BOOM ATTACHMENT
LEFT SIDE

Fig. 1

2.5 GALLON FOAM MARKER INSTALLATION

STEP 9: LEFT SIDE

- Attach the foam marker dropper to the bracket, securing it with 3/8" hose and hose clamp.

NOTICE

Instructions are the same for the 6 nozzle boom.

B

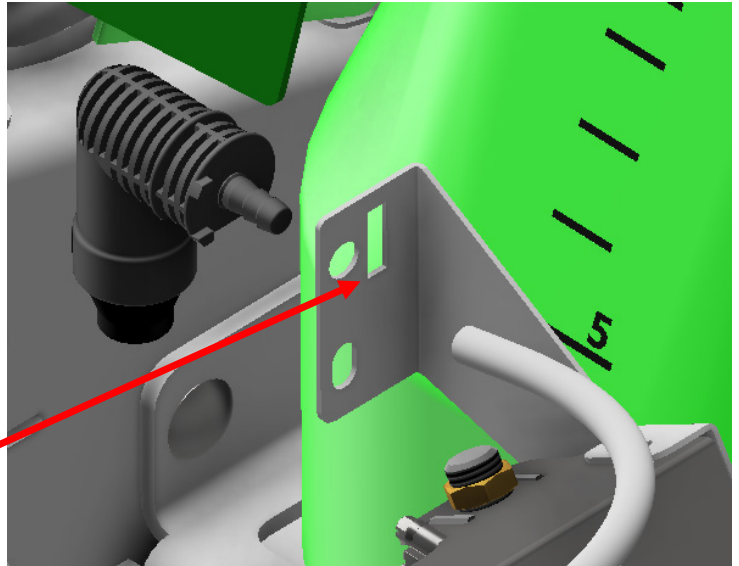

- Connect the other end of the hose to the 3/8" hose barb tee fitting, securing it with 3/8" hose clamp.

B

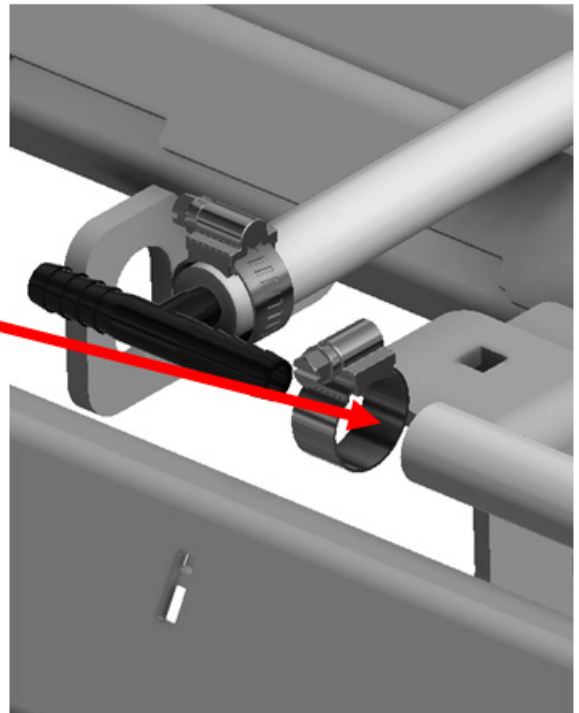

2.5 GALLON FOAM MARKER INSTALLATION

STEP 10: RIGHT SIDE

- Attach the foam marker dropper to the bracket, securing it with 3/8" hose and hose clamp.

NOTICE

Instructions are the same for the 6 nozzle boom.

C

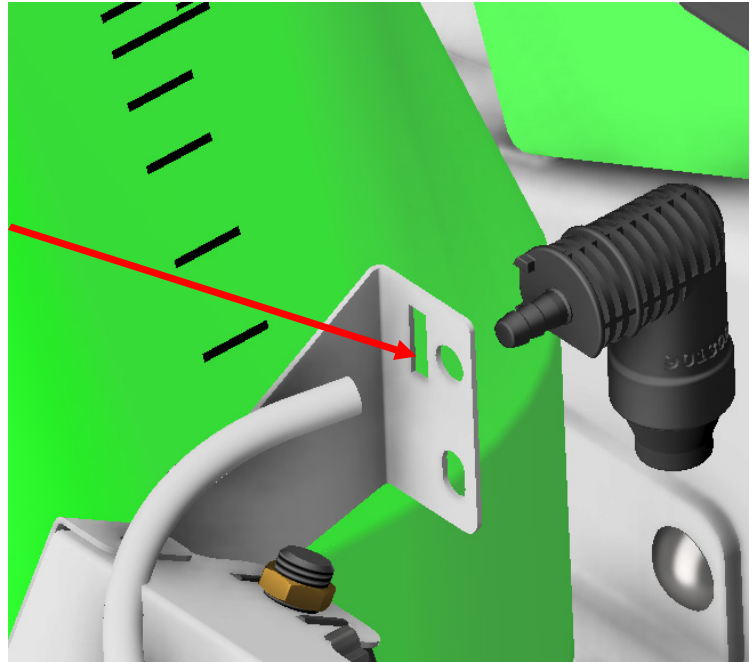

- Connect the other end of the hose to the 3/8" hose barb tee fitting, securing it with 3/8" hose clamp.

C

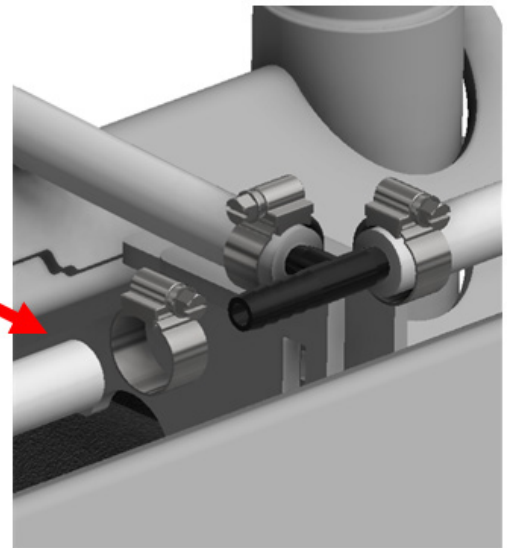

2.5 GALLON FOAM MARKER INSTALLATION

WIRING HARNESS

SG-7G1-2

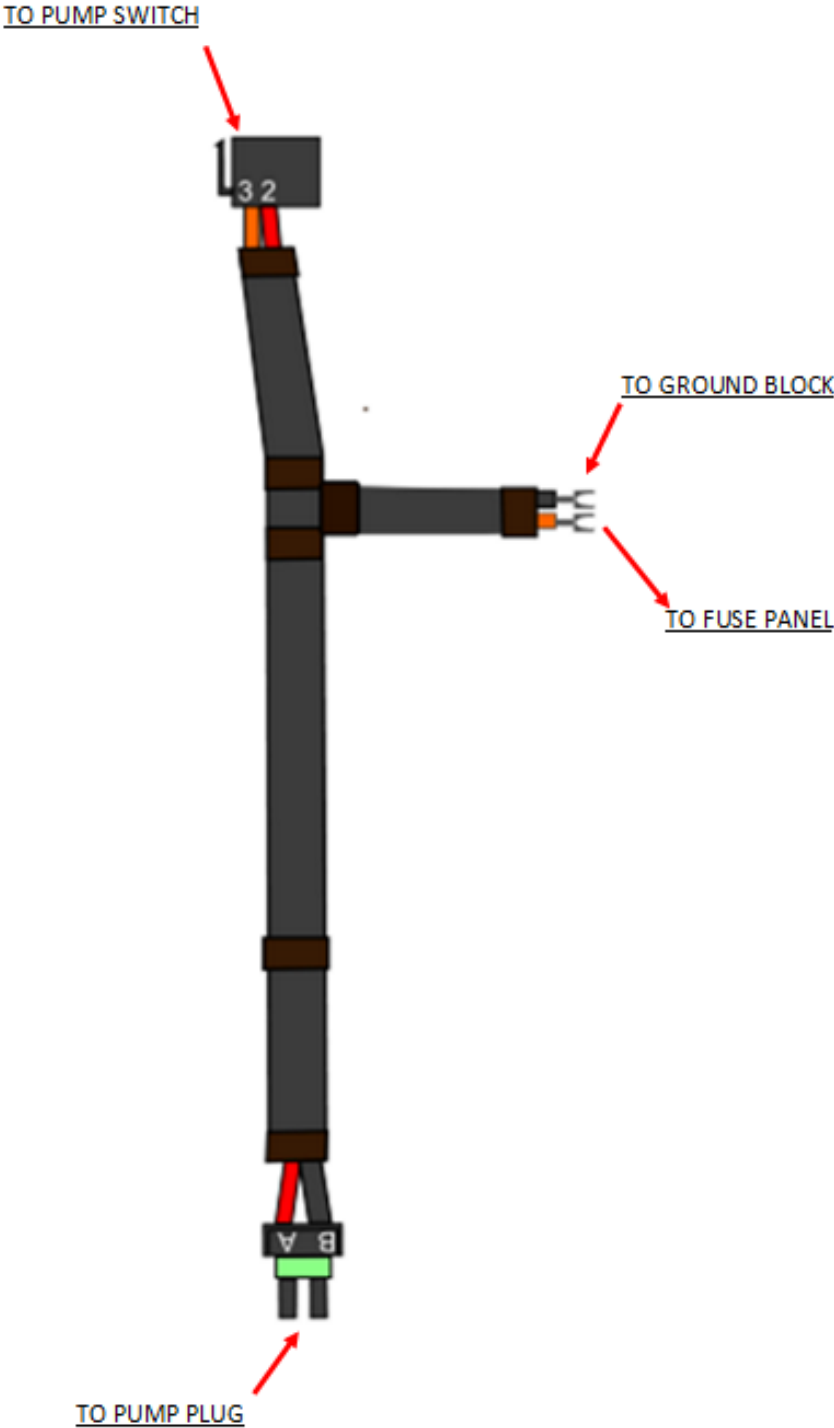

2.5 GALLON FOAM MARKER INSTALLATION

STEP 11:

- Remove the plastic cap from “aux 3” in the panel .
- Attach the “rocker switch” to the dash panel.

NOTICE

The long side of the rocker switch faces down.

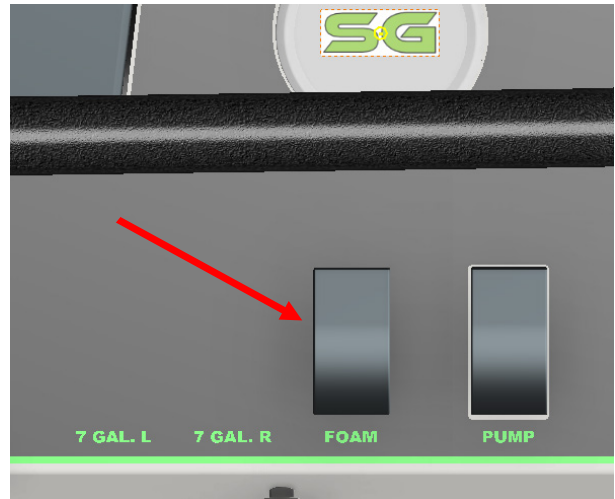

STEP 12: Plug the wiring harness into the rocker switch.

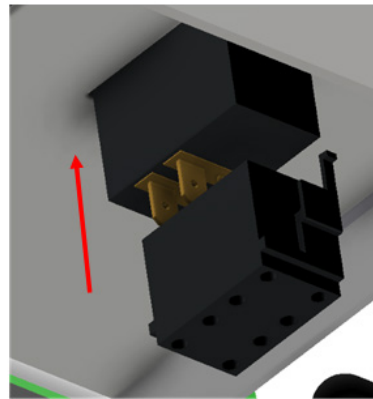

2.5 GALLON FOAM MARKER INSTALLATION

STEP 13:

- Connect the power wire to port 9 on the fuse block (See Fig. 1).
- Connect the ground wire to the ground block.
- Attach the proper fuses according to the chart
- Attach the clear cover to the fuse block.

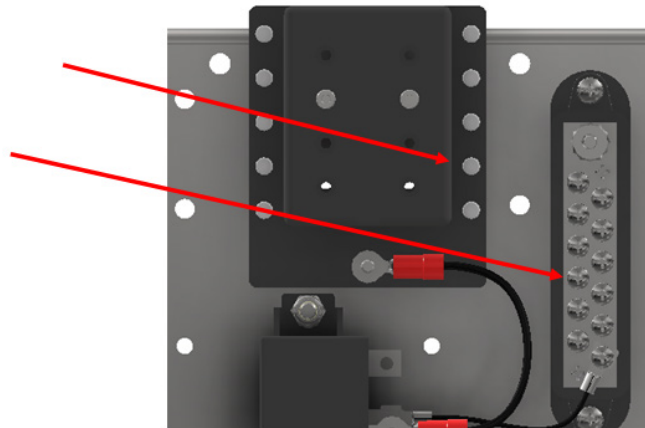

PORT	SG 52 SERIES FUSE BLOCK		PORT
1	SPRAY PUMP 1 25 AMP	USB PORT 5 AMP	6
2	SPRAY PUMP 2 25 AMP	SPRAY PUMP SWITCH 25 AMP	7
3	7 GAL. LEFT 25 AMP	SPEEDOMETER 1 AMP	8
4	7 GAL. RIGHT 25 AMP	FOAM MARKER 25 AMP	9
5	HSA 10 AMP	HEADLIGHT 10 AMP	10

Fig. 1

STEP 14: Connect the plug from the harness to the foam marker pump plug.



2.5 GALLON FOAM MARKER INSTALLATION

STEP 15:

- Reinstall the fuel tank.
- Squeeze the hose clamp and slide it back.
- Reconnect both fuel lines.

! CAUTION
Beware of excess fuel in the hoses & fuel spillage.

! WARNING
Flammable gas.

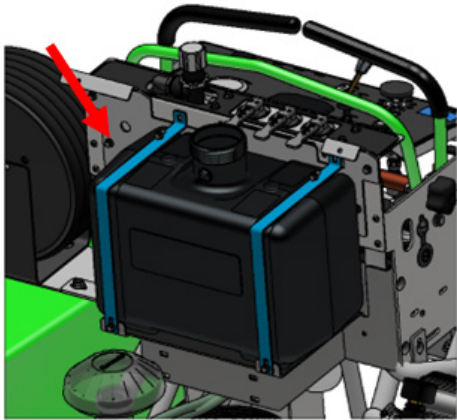

ENGINE SUPPLY HOSE

PRESSURE RELIEF



STEP 16: Reconnect the battery power wire first along with the yellow power wire from the wiring harness, and then reconnect the ground wire.



GROUND

POWER

2.5 GALLON FOAM MARKER INSTALLATION

OPERATION

FILLING THE TANK

CAUTION

- *Wear safety goggles & all proper clothing when operating, servicing or refilling this machine.*
- *Always read & follow manufactures recommendations when handling any chemical.*
- *Do not pump combustible liquids or vapors with this product.*
- *When filling the tank, add WATER FIRST and then FOAMING AGENT.*

- Be sure the power is off.
- Pull the “red” valve to relieve any pressure & remove the cap.
- Starting with a small amount of water (2 gal.), mix the foam concentrate according to the label directions on the foaming agent. If considerably more concentrate is needed above the manufacturer’s suggested ratio (usually 2-5 ounces per gallon) to produce good foam, use of a softener or soft water may be required. If the foam is too stiff or (dry), it may surge out at irregular intervals. Under this condition. Add water until the foam becomes more wet.
- Replace the cap on the tank.

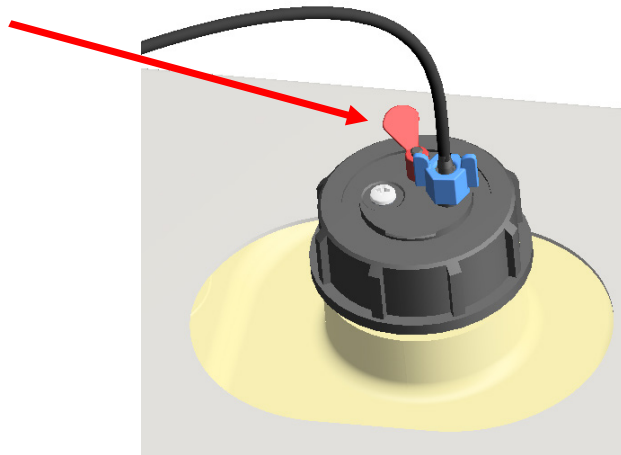

NOTICE

Mixing foam takes some experience. Different water sources may require different amounts of concentrate to obtain the desired foam density. Water hardness, pH, and impurities will affect the rate of concentrate required for a consistent, long-lasting foam.

Different conditions may require different mixing ratios to produce desirable results. It's worthwhile to determine the proper foam/water mixing ratio for your water source with the initial filling. Doing so will save time in the future and aid in consistent foam quality.

If hard water is a problem, commercial softening agents are available. You can make your own softening agent by dissolving a commercial water softening powder (available at most grocery stores) in hot water and adding a portion of the mixture to your tank each time you fill. Experimentation will reveal the correct amount to use. A good starting point is 1-1/2 ounces per gallon of water.

Mix ratios for foam concentrates advertised as 80:1 or 160:1 must be adjusted for use with your water. Such ratios are only a guideline.

Heat, humidity, & wind will also affect the life of the foam. Using a good quality marking agent, such as RUNWAY, may be very important. Liquid dish detergent also works in the foam marker system. You will have to experiment with detergents before using on any special turf applications.

2.5 GALLON FOAM MARKER INSTALLATION

- Start the machine and activate the foam marker and let it prime until it starts dropping suds.

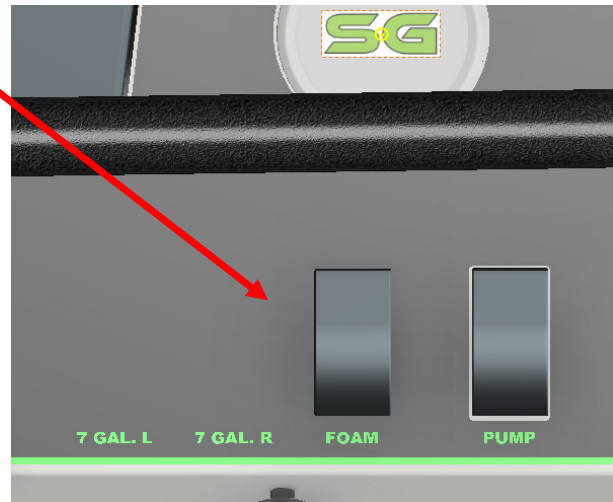

- Turn the foam marker and machine off, Adjust the foam marker for desired timing.

A - Flow control valve, adjust the flow control valve for more or less flow.

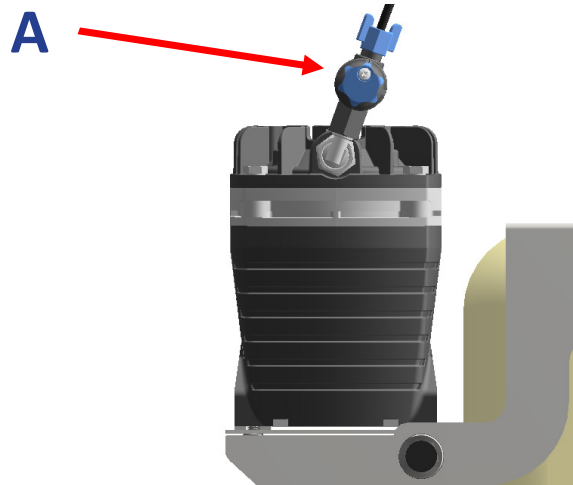

TROUBLE SHOOTING

PROBLEM	SOLUTION
NOT ENOUGH FOAM	<ul style="list-style-type: none"> Add more foam concentrate to the tank. Check for holes in the air line. Clean the screen-strainer & Foam head. Adjust the liquid control valve.
WET FOAM	<ul style="list-style-type: none"> Add more foam concentrate to the tank. Clean the screen-strainer & foam head. Reduce liquid flow.
FOAM IS SURGING	Use less concentrate.
FOAM DOES NOT LAST LONG ON THE GROUND	<ul style="list-style-type: none"> Add more foam concentrate to the tank. Use a high quality foem concentrate like Runway. Use collector heads.
BLOWING FOAM IN WINDY WEATHER	<ul style="list-style-type: none"> Use less concentrate to make wetter foam. Add more water to foam solution. Increase the liquid flow.

NOTES



Steel Green Mfg.
824 S State Road 39
Lebanon, IN 46052
www.steelgreenmfg.com

(765)-481-2890

MANUAL PART NO.	MANUAL REV.	DESCRIPTION	KIT PART NO.
SGM-003	7	2.5 GALLON FOAM MARKER KIT SG/46/52	K299501